



**PURCHASING SECTION**  
13450 – 104 Avenue, Surrey, BC V3T 1V8  
Tel: 604-590-7274  
E-mail: [purchasing@surrey.ca](mailto:purchasing@surrey.ca)

---

**ADDENDUM No. 1**

---

**REQUEST FOR QUOTATION No.:** 1220-040-2017-082

**TITLE:** TEMPORARY FLOW MONITORING SERVICES

**ADDENDUM ISSUE DATE:** JUNE 21, 2017

**CLOSING DATE:** PREFER TO RECEIVE QUOTATIONS ON OR  
BEFORE JULY 4, 2017.

---

**INFORMATION FOR CONTRACTORS**

Contractors are advised that Addendum No. 1 to RFQ 1220-040-2017-082 is hereby issued by the City. This addendum shall form part of the Contract Documents and is to be read, interpreted and coordinated with all other parts. The following information is provided to answer questions raised by Contractors for the above named project, to the extent referenced and shall become a part thereof. No consideration will be allowed for extras due to the Contractor or any sub-contractor not being familiar with this addendum. This Addendum No. 1 contains one (1) page plus two (2) maps for three (3) pages in total.

**Additional site added to the list (Schedule A, section 2.1.1):**

No.	Station Name	Catchment Area	Facility ID	Node ID	Size, Material & Slope*
21	R6	Robson 6	1000106256	1249510026	250 AC, 1.54%

This site will be subject to the same timelines and requirements mentioned within schedule A. Attached are two corresponding maps.

**Delete Schedule A 2.1.2 and replace with the following:**

- 2.1.2 The following sites are on arterial roads or major collectors and will require traffic control for the installation of, inspection of, data retrieval from and removal of the flow monitoring devices: Campbell Heights 1 (CH1), Cloverdale 8 (C8), Cloverdale 10.10 (NCC10.10), North Surrey 4 (NS4), South Surrey 4 (SS4), South Surrey 9 (SS9), South Surrey 10 (SS10) and Robson 6 (R6).

**- END OF ADDENDUM -**

---

All Addenda will become part of the RFQ Documents.

---

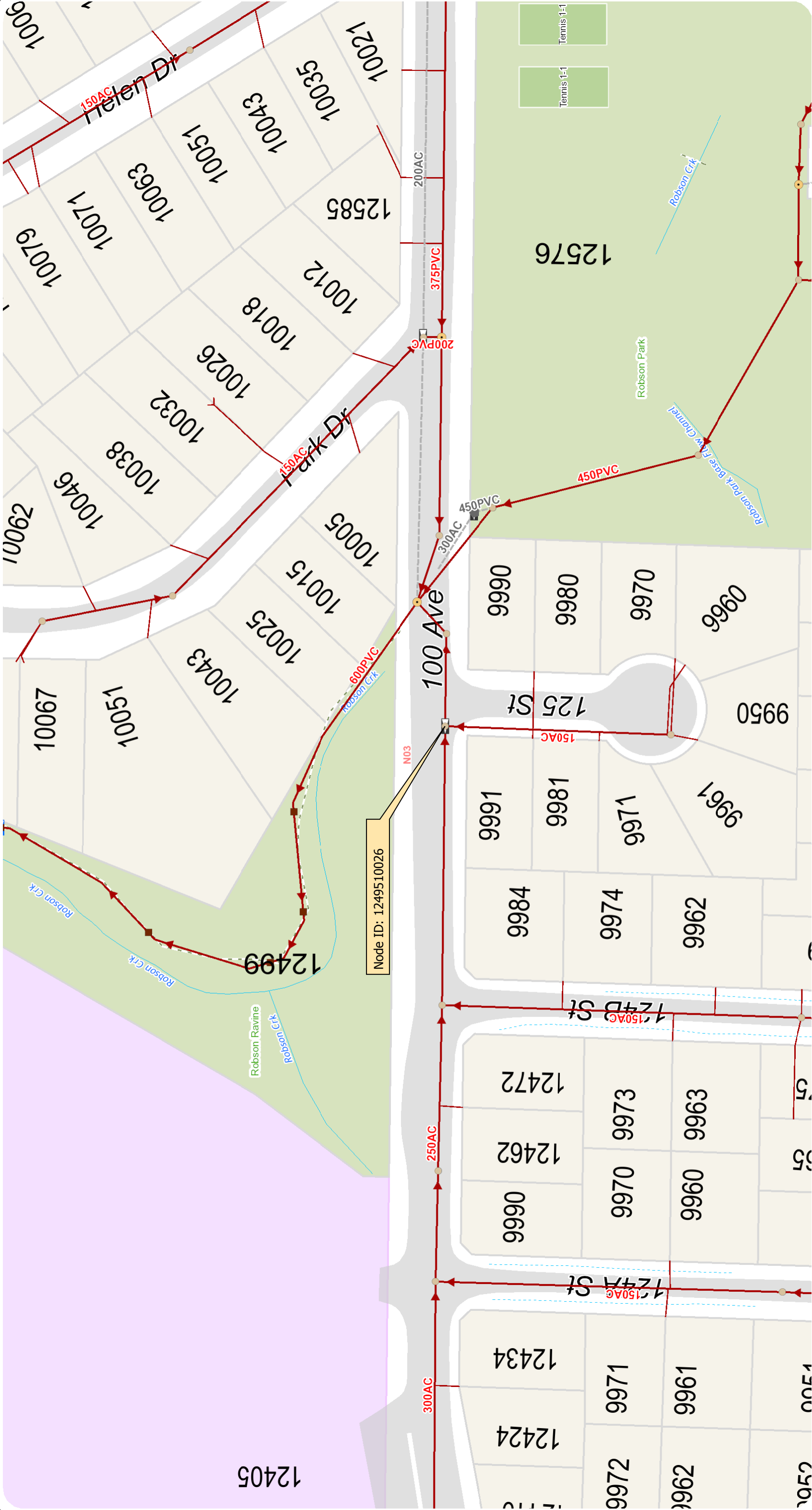

Robson 6 (R6)

Scale: 1:1,000

The data provided is compiled from various sources and is NOT warranted as to its accuracy or sufficiency by the City of Surrey. This information is provided for information and convenience purposes only. Lot sizes, legal descriptions and encumbrances must be confirmed at the Land Title Office. Use and distribution of this map is subject to all copyright and disclaimer notices at [cosmos.surrey.ca](http://cosmos.surrey.ca)

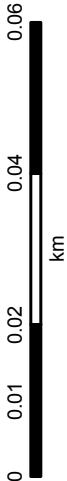





Scale: 1:1,000

The data provided is compiled from various sources and is NOT warranted as to its accuracy or sufficiency by the City of Surrey. This information is provided for information and convenience purposes only. Lot sizes, legal descriptions and encumbrances must be confirmed at the Land Title Office. Use and distribution of this map is subject to all copyright and disclaimer notices at [cosmos.surrey.ca](http://cosmos.surrey.ca)

