

CITY OF SURREY

BY-LAW NO. 13494

A by-law to amend the provisions of "Surrey Land Use and Development Applications Fees Imposition By-law, 1993, No. 11631," as amended.

.....

The Council of the City of Surrey, in open meeting assembled, ENACTS AS FOLLOWS:

1. "Surrey Land Use and Development Applications Fees Imposition By-law, 1993, No. 11631," as amended is hereby further amended as follows:

(1) SCHEDULE FIVE (5) - APPLICATION FEES WITHIN NEIGHBOURHOOD CONCEPT PLAN AREAS AND INFILL AREAS is amended in Section I. Application Surcharge by inserting new Item No. (10) after Item No. (9) as follows:

(10) West Cloverdale North Neighbourhood Concept Plan Area as shown on Map 10	\$146.71 per lot or dwelling unit (or equivalent) calculated on the maximum number of lots or dwelling units allowable on the site after the zoning amendment is granted.
---	---

(2) SCHEDULE FIVE (5) - APPLICATION FEES WITHIN NEIGHBOURHOOD CONCEPT PLAN AREAS AND INFILL AREAS is amended by appending MAP NO. 10. WEST CLOVERDALE NORTH NEIGHBOURHOOD CONCEPT PLAN LANDS SUBJECT TO SURCHARGE, attached hereto and forming part of this By-law as Schedule A, after MAP NO. 9 EAST NEWTON SOUTH NEIGHBOURHOOD CONCEPT PLAN LANDS SUBJECT TO SURCHARGE and before SCHEDULE SIX (6) - OTHER APPLICATION FEES.

2. This By-law shall be cited for all purposes as "Surrey Land Use and Development Applications Fees Imposition By-law, 1993, No. 11631, Amendment By-law, 1998, No. 13494."

PASSED THREE READINGS on the 13th day of July, 1998.

RECONSIDERED AND FINALLY ADOPTED, signed by the Mayor and Clerk, and sealed with the Corporate Seal on the 28th day of July, 1998.

_____MAYOR

_____CLERK

Schedule A to By-law No. 13494

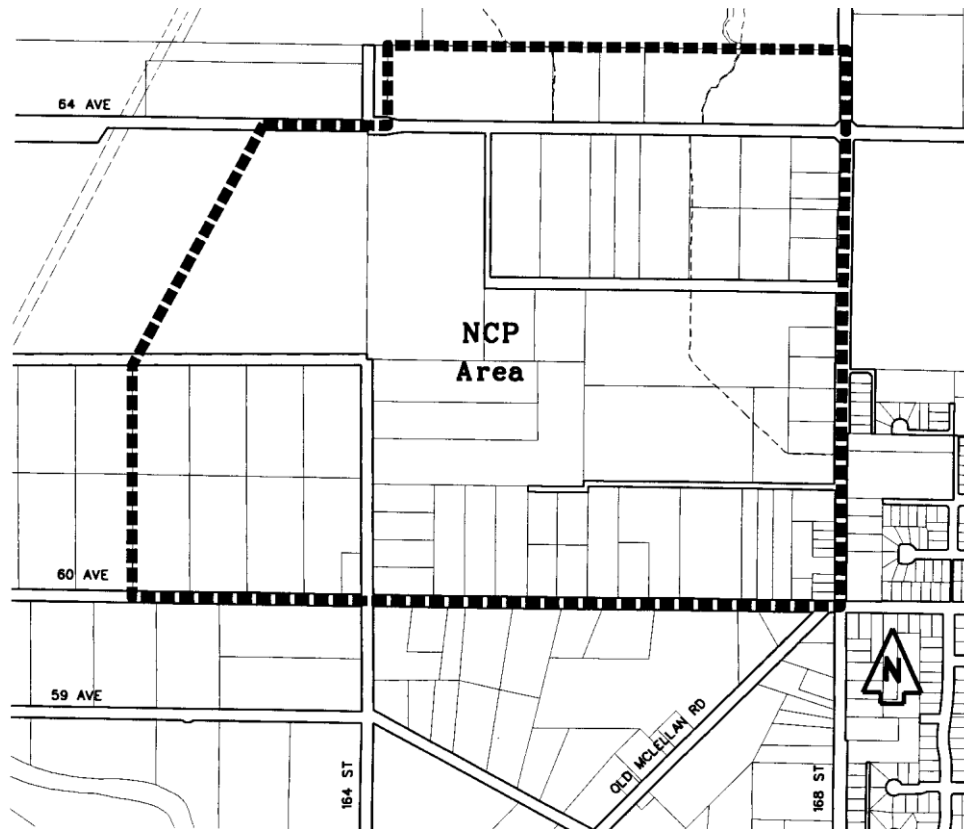

**MAP NO. 10
WEST CLOVERDALE NORTH
NEIGHBOURHOOD CONCEPT PLAN
LANDS SUBJECT TO SURCHARGE**