

CITY OF SURREY

BY-LAW NO. 16577

A by-law to amend the provisions of "Surrey Official
Community Plan By-law, 1996, No. 12900," as amended.

.....

The Council of the City of Surrey, in open meeting assembled, ENACTS AS FOLLOWS:

1. That portion of the map designated as Schedule A. Land Use Designation Map, Division A of "Surrey Official Community Plan By-law, 1996, No. 12900," as amended as shown outlined black on the plan attached hereto and designated as "Amendment to Schedule A, Land Use Designation Map" is hereby amended as follows:

FROM: SUBURBAN (SUB)

TO: URBAN (URB)

Parcel Identifier: 005-798-973

Lot 1 Section 23 Township 1 New Westminster District Plan 73390

2667 - 160 Street

Parcel Identifier: 001-280-775

Lot 1 Section 23 Township 1 New Westminster District Plan 64952

2627 - 160 Street

Parcel Identifier: 012-133-230

Lot A Section 23 Township 1 New Westminster District Plan 79351

2639 - 160 Street

2. This By-law shall be cited for all purposes as "Surrey Official Community Plan By-law, 1996, No. 12900, No. 204 Amendment By-law, 2008, No. 16577."

PASSED FIRST AND SECOND READING on the 11th day of February, 2008.

PUBLIC HEARING HELD thereon on the 25th day of February, 2008.

PASSED THIRD READING on the 25th day of February, 2008.

RECONSIDERED AND FINALLY ADOPTED, signed by the Mayor and Clerk, and sealed with the Corporate Seal on the 12th day of April, 2010.

_____MAYOR

_____CLERK

h:\by-laws\adopted bylaws\2010\byl 16577.doc

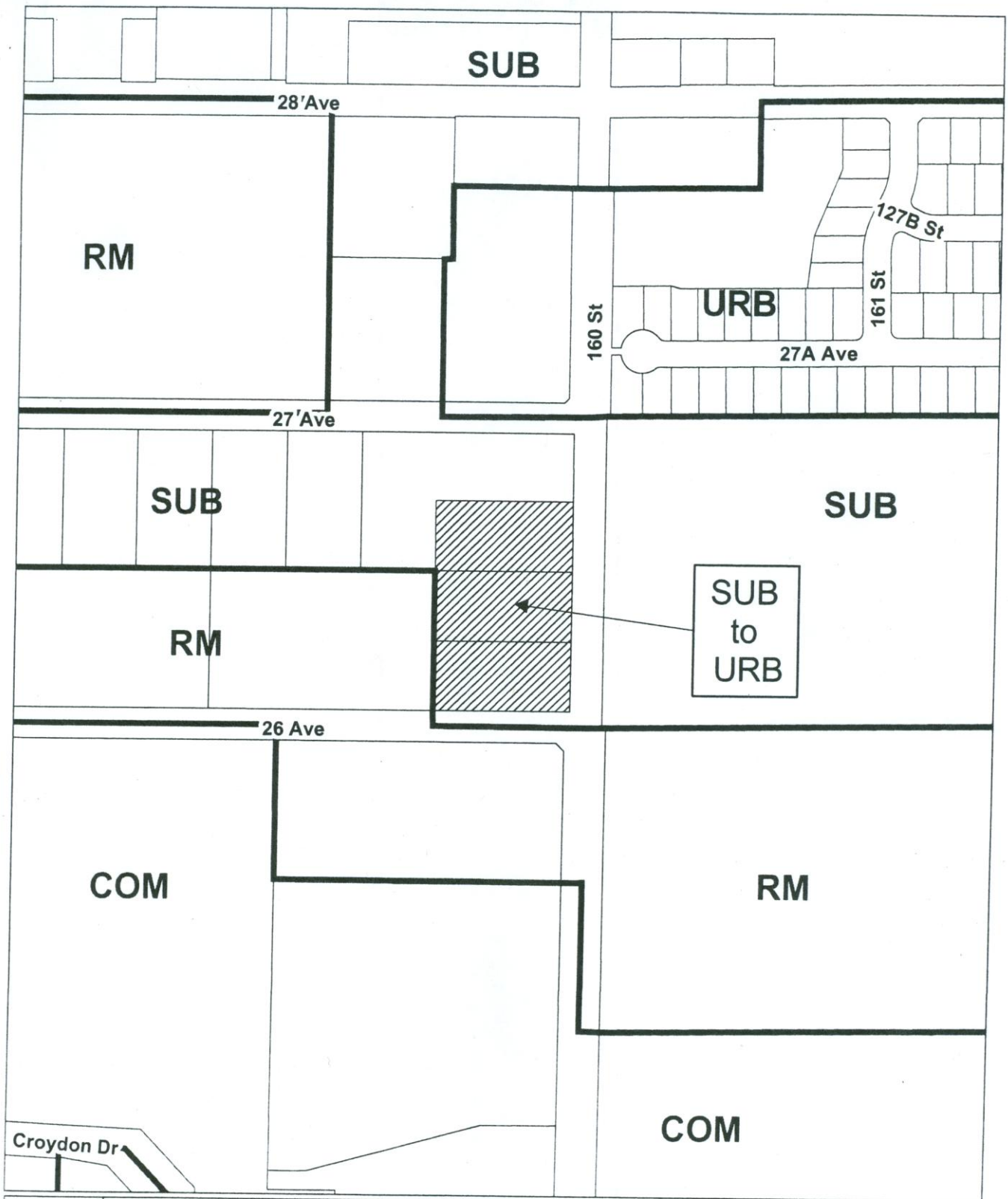

OCP Amendment

Proposed amendment from Suburban to Urban

