

CITY OF SURREY

BY-LAW NO. 16797

A by-law to amend the provisions of "Surrey Official  
Community Plan By-law, 1996, No. 12900," as amended.

.....

The Council of the City of Surrey, in open meeting assembled, ENACTS AS FOLLOWS:

1. That portion of the map designated as Schedule A. Land Use Designation Map, Division A of "Surrey Official Community Plan By-law, 1996, No. 12900," as amended as shown outlined black on the plan attached hereto and designated as "Amendment to Schedule A, Land Use Designation Map" is hereby amended as follows:

FROM: SUBURBAN (SUB)

TO: MULTIPLE RESIDENTIAL (RM)

Parcel Identifier: 007-137-427

Lot 14 Section 23 Township 1 New Westminster District Plan 35390

(2939 - 156 Street)

2. This By-law shall be cited for all purposes as "Surrey Official Community Plan By-law, 1996, No. 12900, No. 229 Amendment By-law, 2008, No. 16797."

PASSED FIRST AND SECOND READING on the 20th day of October, 2008.

PUBLIC HEARING HELD thereon on the 3rd day of November, 2008.

PASSED THIRD READING on the 3rd day of November, 2008.

RECONSIDERED AND FINALLY ADOPTED, signed by the Mayor and Clerk, and sealed with the Corporate Seal on the 3rd day of May, 2010.

\_\_\_\_\_ MAYOR

\_\_\_\_\_ CLERK

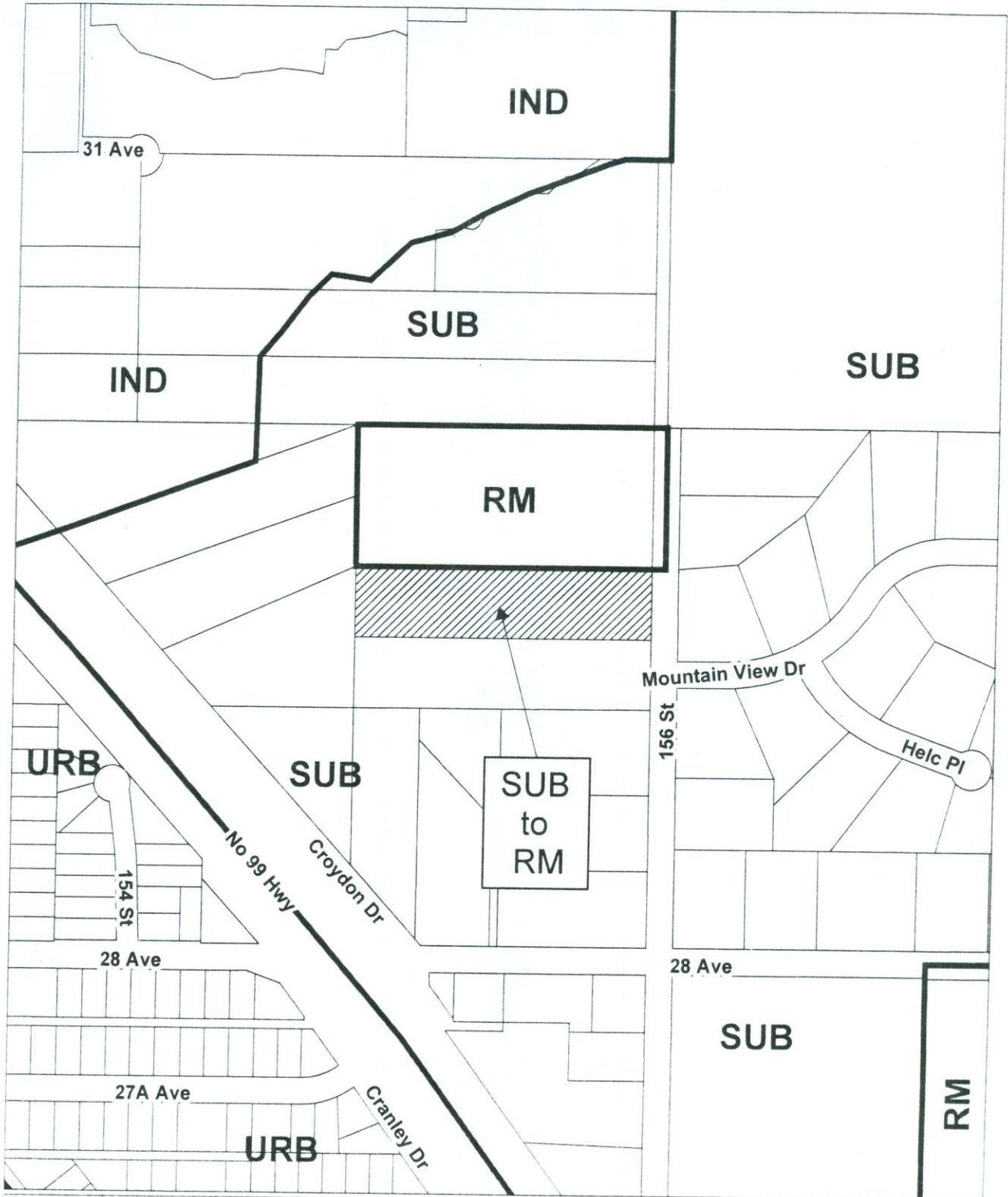

# OCP Amendment

Proposed amendment from Suburban to Multiple Residential

