

CITY OF SURREY

BY-LAW NO. 14813

A By-law to provide for the exemption from taxation of certain properties in the City of Surrey pursuant to Sections 341 and 342 of the "Local Government Act."  
.....

WHEREAS Council may, by authority of Sections 341 and 342 of the Local Government Act, R.S.B.C. 1996, Chap.323, exempt from taxation certain properties;

AND WHEREAS Council deems it expedient to exempt from taxation the properties hereinafter mentioned;

NOW, THEREFORE, Council of the City of Surrey, in open meeting assembled, ENACTS AS FOLLOWS:

**Title**

1. This By-law may be cited as the "Section 341 and 342 Tax Exemption By-law, 2002, No. 14813."

**Exemptions**

2. The following lands or improvements, or portion thereof, are hereby exempt from taxation for the Year 2003 in the City of Surrey pursuant to Sections 341 and 342 of the Local Government Act, R.S.B.C. 1996, Chap.323 as amended:

- (1) Land and improvements on land legally described as Lot 49, Section 22, Block 5 North, Range 2 West, New Westminster District, Plan 9117.  
PID 011-384-352  
Section 341(2)(c)

Civic Address: 10734 - 135 Street  
Owned By: Surrey Food Bank Foundation  
(Incorporated Society No. S-27681)  
Folio No. 2220-48002-1/Map 011  
Applicant's Name: **Surrey Food Bank**

- (2) Land and improvements on land legally described as  
Lot 44, Section 22, Block 5 North, Range 2 West, New Westminster District,  
Plan 9117.  
PID 011-384-301  
Section 341(2)(c)
- Civic Address: 10682 - 135 Street  
Owned By: SRS Vocational Services Society (Incorporated Society No. 10656)  
Folio No. 2220-43002-9/Map 011  
Applicant's Name: **SRS Vocational Services Society**
- (3) Land and improvements on land legally described as  
Lot 45, Section 22, Block 5 North, Range 2 West, New Westminster District,  
Plan 9117.  
PID 011-384-310  
Section 341(2)(c)
- Civic Address: 10694 - 135 Street  
Owned By: SRS Vocational Services Society (Incorporated Society No. 10656)  
Folio No. 2220-44002-3/Map 011  
Applicant's Name: **SRS Vocational Services Society**
- (4) Land and improvements legally described as  
Lot 46, Section 22, Block 5 North, Range 2 West, New Westminster District,  
Plan 9117.  
PID 011-384-328  
Section 341(2)(c)
- Civic Address: 10704 - 135 Street  
Owned By: SRS Vocational Services Society (Incorporated Society No. 10656)  
Folio No. 2220-45002-8/Map 011  
Applicant's Name: **SRS Vocational Services Society**
- (5) Land and improvements on land legally described as  
Strata Lot 1, Section 21, Block 5 North, Range 2 West, New Westminster  
District, Strata Plan NW 1822 together with an interest in the common property  
in proportion to the unit entitlement of the strata lot as shown on Form 1.  
PID 002-012-171  
Section 341(2)(c)
- Civic Address: 12817 - 104 Avenue  
Owned by: The John Howard Society of the Lower Mainland of B.C.  
(Incorporated Society No. S-25060) (Registered Charity No. 10754-2573)  
Folio No. 2210-98003-3/Map 011  
Applicant's Name: **Hogben House**

- (6) Land and improvements on land legally described as  
Strata Lot 2, Section 21, Block 5 North, Range 2 West, New Westminster  
District, Strata Plan NW 1822 together with an interest in the common property  
in proportion to the unit entitlement of the strata lot as shown on Form 1.  
PID 002-012-189  
Section 341(2)(c)
- Civic Address: 12819 - 104 Avenue  
Owned by: The John Howard Society of the Lower Mainland of B.C.  
(Incorporated Society No. S-25060) (Registered Charity No. 10754-2573)  
Folio No. 2210-98004-5/Map 011  
Applicant's Name: **Hogben House**
- (7) Land and improvements on land legally described as Lot 1, Except: Part on Plan  
with By-law filed A14399; Section 24, Block 5 North, Range 2 West, New  
Westminster District, Plan 16807.  
PID 010-205-772  
Section 341(2)(c)
- Civic Address: 14069 – 104 Avenue  
Owned by: The Governing Council of the Salvation Army, Canada West  
(Registered Charity No. 10795-1618)  
Folio No. 2240-00014-4/Map 012  
Applicant's Name: **The Salvation Army - Surrey**
- (8) Land and improvements on land legally described as  
Lot "A", Section 14, Block 5 North, Range 2 West, New Westminster District,  
Plan 18030.  
PID 010-345-965  
Section 341(2)(c)
- Civic Address: 13690 – 111A Avenue  
Owned By: **OPTIONS: Services to Communities Society**  
(Incorporated Society No. S-10398) (Registered Charity No. 0493247-0927)  
Folio No. 2140-90021-2/Map 012  
Applicant's Name: **OPTIONS: Services to Communities Society**
- (9) Land and improvements on land legally described as  
Lot 147, Section 19, Block 5 North, Range 1 West, New Westminster District,  
Plan 48517.  
PID 002-582-376  
Section 341(2)(c)
- Civic Address: 14668 – 106 Avenue  
Owned by: **OPTIONS: Services to Communities Society**  
(Incorporated Society No. S-10398) (Registered Charity No. 0493247-0927)  
Folio No. 1190-79602-8/Map 013  
Applicant's Name: **OPTIONS: Services to Communities Society**

- (10) Land and improvements on land legally described as Lot A, Section 19, Block 5, Range 1 West, New Westminster District, Plan LMP48242  
PID 024-912-981  
Section 341(2)(g)

Civic Address: 14568 - 104A Avenue  
Owned by: Guildford Seniors Village Holdings Ltd.  
(Community Care Facility License No. 0983007)  
Folio No. 1190-90006-3/Map 013  
Applicant's Name: **Guildford Seniors Village**

- (11) Land and improvements on land legally described as  
Lot 1, Section 14, Block 5 North, Range 1 West, New Westminster District,  
Plan LMP19036.  
PID 018-962-904  
Section 341(2)(c)

Civic Address: 16321 - 108 Avenue  
Owned By: Bethesda Christian Foundation Society (Incorporated Society  
No. S-37317)  
Folio No. 1141-00014-3/Map 015  
Applicant's Name: **Bethesda Christian Association**

- (12) Land and improvements on land legally described as  
Lot "A", Section 36, Block 5 North, Range 3 West, New Westminster District,  
Plan 19953.  
PID 010-588-051  
Section 341(2)(g)

Civic Address: 11861 – 99 Avenue  
Owned By: Kamon Holdings Ltd. (Inc. No. 591491)  
(Community Care Facility Licence No. 0982879)  
Folio No. 3360-90018-2/Map 019  
Applicant's Name: **Centennial Park Lodge**

- (13) Land and improvements on land legally described as  
Lot 60, Section 28, Block 5 North, Range 2 West, New Westminster District,  
Plan 32952.  
PID 003-583-813  
Section 341(2)(c)

Civic Address: 10080 – 128 Street  
Owned By: OPTIONS: Services to Communities Society  
(Incorporated Society No. S-10398) (Registered Charity No. 0493247-0927)  
Folio No. 2280-54501-9/Map 021  
Applicant's Name: **OPTIONS: Services to Communities Society**

- (14) That portion of land and improvements on land legally described as Lot A Except: Firstly: Parcel One (Explanatory Plan 14541), Secondly: Part Road on Plan LMP 14905, Section 35, Block 5, North Range 2 West New Westminster District Plan 13113.

PID 009-770-381

Section 341(2)(c) & (n)

Civic Address: 9815 – 140 Street

Owned by: City of Surrey

Folio No. 2350-90012-5/Map 022

Applicant's Name: **Surrey Community Services Society** (Incorporated Society No. 9117)

- (15) That portion of land and improvements on land legally described as Lot 3 Except: Firstly: North 70 feet, Secondly: Parcel J (By-law Plan 50570), Thirdly: Part on Highway Statutory Right of Way. Plan 62493; Section 35, Block 5 North, Range 2, West, New Westminster District, Plan 14725.

PID 013-636-162

Section 341(2)(g)

Civic Address: 9634 King George Highway

Owned By: South Fraser Health Region

Folio No. 2350-02014-9/Map 022

Applicant's Name: **Shirley Dean Pavilion**

- (16) Strata Lots 7, 11 and 12, all of Section 29, Block 5 North, Range 1 West, New Westminster District, Strata Plan NW2493 together with an interest in the common property in proportion to the unit entitlement of the Strata Lots as shown on Form I.

PID 005-729-874 (Lot 7)

1290-98192-9

PID 005-729-947 (Lot 11 - Unit #101)

1290-98196-6

PID 005-729-998 (Lot 12 - Unit #102)

1290-98197-8

Section 341(2)(b) & (c)

Civic Address: 14914 - 104 Avenue

Owned By: Scout Properties (B.C./Yukon) Ltd. (Co. Incorporated Society No. 162141)/Map 023

Applicant's Name: **Boy Scouts of Canada, Fraser Valley Region**

- (17) That portion of Strata Lot 52, Section 28, Block 5, North Range 1, Plan 58484,  
leased and occupied for public worship.  
PID 001-184-342  
Section 341(2)(k)

Civic Address: B103, 15310 - 103A Avenue  
Owned By: Yorkson Investments Co.  
Folio No. 1280-50502-3/Map 024  
Applicant's Name: **Surrey Pentecostal Assembly**

- (18) Land and improvements on land legally described as  
Lot "B" Except: Part Subdivided by Plan 37396, Section 31, Township 2,  
New Westminster District, Plan 6922.  
PID 011-253-185  
Section 341(2)(b)

Civic Address: 8870 - 120 Street  
Owned By: Kennedy Community Hall Association  
(Incorporated Society No. S-2646)  
Folio No. 6312-91001-5/Map 030  
Applicant's Name: **Kennedy Community Hall**

- (19) That 1440 sq. ft. portion of land and improvements on land legally described as  
Lot 7, Section 32, Township 2, New Westminster District, Plan NWP88116,  
and shown hatched on the plan attached hereto.  
PID 017-136-733  
Section 341(2)(c)

Civic Address: 8888 - 128 Street  
Owned By: Pentecostal Assemblies of Canada (Incorporated Society  
No. S16419)  
Folio No. 6322-06005-3/Map 031  
Applicant's Name: **Premier Pas Preschool Society**  
(Incorporated Society No. S-17407)

- (20) Land and improvements on land legally described as Lot 233, South East Half  
Section 32, Township 2, New Westminster District, Plan 51486  
PID 004-938-178  
Section 341(2)(k)

Civic Address: 9061 King George Highway  
Owned by: Outside Investments Ltd.  
Folio No. 6321-88202-1/Map 031  
Applicant's Name: **Grace Baptist Church**

- (21) That portion of land and improvements on land legally described as Lot 18, Section 33, Township 2, New Westminster District, Plan 17255, Except the 800 square foot separate day care building.  
PID 005-344-689  
Section 341(2)(g)

Civic Address: 13729 – 92 Avenue  
Owned by Bonnymuir Holdings Ltd (Certificate of Incorporation No. 265299)  
(Community Care Facility License No. 0982945)  
Folio No. 6333-17002-1/Map 032  
Applicant's Name: **Bonnymuir Lodge**

- (22) Land and improvements on land legally described as Parcel A, Section 33, Township 2, New Westminster District, Reference Plan 78416.  
PID 011-585-455  
Section 341(2)(g)

Civic Address: 13646 - 94A Avenue  
Owned By: Bear Creek Lodge Ltd. (Co. Incorporated Society No. 336746)  
(Community Care License No. 0920062)  
Folio No. 6333-90003-5/Map 032  
Applicant's Name: **Bear Creek Lodge**

- (23) Land and improvements on land legally described as Lot 3, Section 33, Township 2, New Westminster District, Plan 52522.  
PID 005-036-097  
Section 341(2)(c)

Civic Address: 9460 - 140 Street  
Owned By: Lower Fraser Valley Cerebral Palsy Association  
(Incorporated Society No. S-4418)  
Folio No. 6334-02002-X/Map 032  
Applicant's Name: **South Fraser Child Development Centre**

- (24) Land and improvements on land legally described as Parcel "B" (Plan with Fee Deposited No. 15329F), North West Quarter, Section 31, Township 8, New Westminster District.  
PID 013-238-558  
Section 341(2)(b)

Civic Address: 9568 - 168 Street  
Owned By: Tynehead Community Association  
(Incorporated Society No. S-5773)  
Folio No. 8313-91002-1/Map 036  
Applicant's Name: **Tynehead Community Hall**

- (25) Strata Lot 15, Section 30, Township 2, New Westminster District, Strata Plan NW2882, together with an interest in the common property in proportion to the unit entitlement of the strata lot as shown on Form 1.  
PID 012-427-641  
Section 341(2)(c)

Civic Address: #109-12414 - 82 Avenue  
Owned By: Progressive Inter-Cultural Community Services Society  
(Society Incorporated No. S22870)  
Folio No. 6301-98021-9/Map 040  
Applicant's Name: **Progressive Inter-Cultural Community Services Society**

- (26) Strata Lot 16, Section 30, Township 2, New Westminster District, Strata Plan NW 2882, together with an interest in the common property in proportion to the unit entitlement of the strata lot as shown on Form 1.  
PID 012-427-659  
Section 341(2)(c)

Civic Address: #110, 12414 - 82 Avenue  
Owned By: Progressive Inter-Cultural Community Services Society  
(Society Incorporated No. S22870)  
Folio No. 6301-98022-0/Map 040  
Applicant's Name: **Progressive Inter-Cultural Community Services Society**

- (27) Land and improvements on land legally described as Lot 15, SE Section 30, Township 2, New Westminster District, Plan WS3424, Part SE1/4, Strata.  
PID 016-941-420  
Section 341(2)(c)

Civic Address: #15, 12484 - 82 Avenue  
Owned By: Surrey Community Crime Prevention Society (Incorporated Society No. S18761)  
Folio No. 6301-98081-5/Map 040  
Applicant's Name: **Surrey Crime Prevention Society**

- (28) Strata Lot 12, Section 30, Township 2, New Westminster District Strata Plan LMS72 Together with an interest in the common property in proportion to the unit entitlement of the strata lot.  
PID 017-397-391  
Sections 341(2)(c) & (i)

Civic Address: #12 - 8473 - 124th Street  
Owned By: Shree Sanatan Dharam Sabha (FIJI) of B.C.(Incorporated Society No. S-0033285)  
Folio No. 6303-98067-3/Map 040  
Applicant's Name: **Shree Sanatan Dharam Sabha (FIJI) of B.C.**



- (29) Strata Lots 14 and 15, all of Section 29, Township 2, New Westminster District LMS 949 together with an interest in the common property in proportion to the unit entitlement of the Strata Lots as shown on Form 1, SAVE AND EXCEPT the upper floor which is leased to a private firm.  
PID 018-329-900 (Lot 14) 6293-98033-5  
PID 018-329-918 (Lot 15) 6293-98034-7  
Section 341(2)(c)

Civic Address #115, 12975 – 84 Avenue  
Owned by: Greater Vancouver Youth for Christ (Incorporated Society No. 8103)/Map 041  
Applicant's Name: **Greater Vancouver Youth for Christ (Surrey)**

- (30) That portion of land and improvements on land legally described as Lot 12 Except: Parcel "A" (Explanatory Plan 23281), North East Quarter, Section 29, Township 2, New Westminster District, Plan 5488, and limited to 7,000 square feet of land and 12,000 square feet of improvements.  
PID 006-159-907  
Section 341(2)(k)

Civic Address: 8580 - 132 Street  
Owned By: Sher-A-Punjab Community Centre Corporation (Co. Incorporated Society No. 320596)  
Folio No. 6294-11002-6/Map 041  
Applicant's Name: **Bear Creek Punjab Cultural Society**

- (31) Land and improvements on land legally described as Lot 1, SE Section 26, Township 2, New Westminster District, Plan LMP27235  
PID 023-343-443  
Section 341(2)(g)

Civic Address: 15640 - 84 Avenue  
Owned By: Grandville Pacific Capital Corp.  
Folio No. 6261-00038-4/Map 044  
Applicant's Name: **Evergreen Cottages Corporation**  
(Community Care Facility License No. 0983008)

- (32) Land and improvements on land legally described as Parcel "B" (Reference Plan 7783) Lot 13, Except: Parcel "Two" (By-law Plan 84225); Section 26, Township 2, New Westminster District, Plan 6486.  
PID 011-194-286  
Sections 341(2)(k)

Civic Address: 8415 - 160 Street  
Owned By: Greek Orthodox Community of Surrey and Fraser Valley Association (Incorporated Society No. S-27472)  
Folio No. 6264-12004-2/Map 044  
Applicant's Name: **Greek Orthodox Community of Surrey and Fraser Valley**

- (33) Land and improvements on land legally described as  
Parcel "B" (Reference Plan 2880) Lot 13, Section 19, Township 2,  
New Westminster District, Plan 1022.  
PID 017-082-200  
Section 341(2)(b)
- Civic Address: 12152 - 75 Avenue  
Owned By: Strawberry Hill Farmer's Institute  
(Agricultural Associations Act, 1914, Incorporated Society No. 87)  
Folio No. 6192-12006-7/Map 050  
Applicant's Name: **Strawberry Hill Farmer's Institute**
- (34) Land and improvements on land legally described as  
Lot 203, Section 20, Township 2, New Westminster District, Plan 62200.  
PID 001-093-347  
Section 341(2)(k)
- Civic Address: #4, 13570 – 78 Avenue  
Owned by: Mason Investments Ltd.  
Folio No. 6204-85202-4/Map 051  
Applicant's Name: **Destiny Christian Association**  
(Incorporated Society No. S-30296)
- (35) Land and improvements on land legally described as  
Lot "A", Section 20, Township 2, New Westminster District, Plan 20189.  
PID 008-670-684  
Section 341(2)(c) & (n)
- Civic Address: 13455 - 72 Avenue  
Owned By: City of Surrey  
Folio No. 6201-90010-X/Map 051  
Applicant's Name: **Options: Services to Communities Society**  
(Incorporated Society No. 10398) (Handi-Dart)  
(Registered Charity No. 0493247-0927)
- (36) Strata Lots 8 and 9, all of Section 20, Township 2, New Westminster District,  
Strata Plan LMS 1181 together with an interest in the common property in  
proportion to the unit entitlement of the Strata Lots as shown on Form 1.  
PID 018-564-569 (Lot 8, Unit 208) 6203-98092-4  
PID 018-564-577 (Lot 9, Unit 209) 6203-98093-6  
Section 341(2)(b)
- Civic Address: Units 208 and 209, 7750 – 128 Street  
Owned by: The Muslim Youth Centre/Map 051  
(Incorporated Society No. S-40714)  
Applicant's Name: **The Muslim Youth Centre**

- (37) Strata Lot 31, Section 20, Township 2, New Westminster District, Strata Plan NW3244, together with an interest in the common property in proportion to the unit entitlement of the Strata Lot as shown on Form 1.  
 PID 016-036-166  
 Section 341(2)(c)
- Civic Address: #206, 12837 - 76 Avenue  
 Owned By: Seaton Woodward Foundation (Incorporated Society No. S-11884)  
 Folio No. 6203-98049-3/Map 051  
 Applicant's Name: **Surrey & White Rock Home Support Association**
- (38) Strata Lot 30, Section 20, Township 2, New Westminster District, Strata Plan NW3244, together with an interest in the common property in proportion to the unit entitlement of the Strata Lot as shown on Form 1.  
 PID 016-036-158  
 Section 341(2)(c)
- Civic Address: #217, 12837 - 76 Avenue  
 Owned By: Seaton Woodward Foundation (Incorporated Society No. S-11884)  
 Folio No. 6203-98048-1/Map 051  
 Applicant's Name: **Surrey and White Rock Home Support Association**
- (39) Strata Lot 41, Section 20, Township 2, New Westminster District, Strata Plan NW3244, together with an interest in the common property in proportion to the unit entitlement of the strata lot as shown on Form 1.  
 PID 016-036-263  
 Section: 341(2) (c) & (i)
- Civic Address: #211, 12837 - 76 Avenue  
 Owned By: British Columbia Genealogical Society  
 (Incorporated Society No. 13718)  
 Folio: 6203-98059-6/Map 051  
 Applicant's Name: **B.C. Genealogy Society**
- (40) Land and improvements on land legally described as  
 Lot 4, Section 18, Township 2, New Westminster District, Plan 83719  
 PID 015-329-143  
 Section 341(2)(c)
- Civic Address: 6999 - 124 Street  
 Owned By: Satnam Education Society of B.C.(Incorporated Society  
 No. S21979)  
 Folio No. 6183-03018-1/Map 060  
 Applicant's Name: **Satnam Education Society of British Columbia  
 (Preschool and Daycare)**

- (41) Land and improvements on land legally described as  
Lot 2, Section 18, Township 2, New Westminster District, Plan 87090.  
PID 016-675-401  
Section 341(2)(c)
- Civic Address: 6445 – 121 Street  
Owned by: Provincial Rental Housing Corporation (Incorporated Society  
No. 52129)  
Folio No. 6185-01042-2/Map 060  
Applicant's Name: **Habitat Housing Society**  
(Registered Charity No. 0902320-09)
- (42) Land and improvements on land legally described as  
Lot 493, Section 17, Township 2, New Westminster District, Plan 62718.  
PID 003-154-050  
Section 341(2)(c)
- Civic Address: 13582 – 68 Avenue  
Owned by: **OPTIONS: Services to Communities Society**  
(Incorporated Society No. S-10398) (Registered Charity No. 0493247-0927)  
Folio No. 6171-48010-1/Map 061  
Applicant's Name: **OPTIONS: Services to Communities Society**
- (43) That portion of land and improvements on land legally described as Lot 52,  
Section 17, Township 2, New Westminster District, Plan 55458 and Lot 56,  
Section 17, Township 2, New Westminster District, Plan 58570, leased and  
occupied the purpose of public worship.  
PID 001-540-289  
Section 341(2)(k)
- Civic Address: #210, 7093 King George Highway  
Owned By: 329578 B.C. Ltd.  
Folio No. 6174-50504-2/Map 061  
Applicant's Name: **"Heal My People" - International Outreach Canada  
Association dba Celebration Life Church**
- (44) Land and improvements on land legally described as  
Lot 18 Except: Firstly: Parcel "F" (Explanatory Plan 14714) Secondly: Part on  
By-law Plan 57865, Section 16, Township 2, New Westminster District,  
Plan 6066.  
PID 003-927-067  
Section 341(2)(g)
- Civic Address: 13855 - 68 Avenue  
Owned By: Regency Intermediate Care Facilities Incorporated  
(Co. Incorporated No. 344598)  
(Community Care Facility No. 0904335)

Folio No. 6163-17002-7/Map 062  
Applicant's Name: **Regency Care Home**

- (45) Land and improvements on land legally described as  
Lot 1, Section 15, Township 2, New Westminster District, Plan LMP51687  
PID 025-175-009  
Section 341(2)(k)

Civic Address: 15177 - 68 Avenue  
Owned By: Fraser Valley Self Help Society (Incorporated Society No. S-31319)  
Folio No. 6154-00007-8/Map 063  
Applicant's Name: **Ismaili Jamatkhanas (Prayer Facility)**

- (46) Land and improvements on land legally described as  
North East 80 Feet by 100 Feet, Lot 3, Section 17, Township 8, New  
Westminster District, Plan 3420, having a frontage of 80 Feet on Hall's Prairie  
Road by Uniform depth of 100 Feet and adjoining Lot 2.  
PID 010-901-736  
Section 341(2)(i)

Civic Address: 7027 - 184 Street  
Owned By: Surrey Little Theatre (Incorporated Society No. S-5611)  
Folio No. 8174-02002-0/Map 067  
Applicant's Name: **Surrey Little Theatre**

- (47) Land and improvements on land legally described as  
Lot 7, Section 17, Township 8, New Westminster District, Plan 83046.  
PID 015-103-927  
Section 341(2)(c)

Civic Address: 6552 Claytonwood Place  
Owned By: The Semiahmoo Foundation (Incorporated Society No. S-26008)  
(Registered Charity No. 0870451-3)  
Folio No. 8171-06003-1/Map 067  
Applicant's Name: **The Semiahmoo Foundation**

- (48) Land and improvements on land legally described as  
Lot 31, Section 8, Township 2, New Westminster District, Plan 76357.  
PID 009-346-112  
Section 341(2)(c)

Civic Address: 5919 – 133A Street  
Owned By: The Semiahmoo Foundation (Incorporated Society No. 26008S)  
(Registered Charity No. 0870451-3)  
Folio No. 6081-30002-X/Map 071  
Applicant's Name: **The Semiahmoo Foundation**

- (49) Land and improvements on land legally described as  
Lot 4, Section 10, Township 2, New Westminster District, Plan LMP24916  
PID 023-208-589  
Section 341(2)(b) & (c)
- Civic Address: 14988 - 57 Avenue  
Owned By: Young Men's Christian Association of Greater Vancouver & City of Surrey  
Folio No. 6101-03007-6/Map 073  
Applicant's Name: **Surrey YMCA**
- (50) Land and improvements on land legally described as  
Lot A Section 10, Township 2, New Westminster District, Plan LMP41935  
PID 024504-505  
Section 341(2)(b) & (c)
- Civic Address: 15011 - 57 Avenue  
Owned By: Young Men's Christian Association of Greater Vancouver & City of Surrey  
Folio No. 6101-90006-X-6/Map 073  
Applicant's Name: **Surrey YMCA**
- (51) That portion of land and improvements on land legally described as  
Lot 45, Section 10, Township 2, New Westminster District, Plan 1361,  
and shown hatched on the plan attached hereto.  
PID 012-136-191  
Section 341(2)(c)
- Civic Address: 6042 - 148 Street  
Owned By: The Trustees of the Bethany Newton United Church  
(Incorporated Society No. S-21828)  
Folio No. 6104-44002-2/Map 073  
Applicant's Name: **Canadian Association for Proximal Stabilization of  
Cerebral Palsy Children**
- (52) Land and improvements legally described as  
Parcel "5" (Reference Plan 6696) North West Quarter, Section 11, Township 2,  
Except: Firstly: Parcel "One" (Explanatory Plan I0684), Secondly: Parcel "C"  
(By-law Plan 62479), New Westminster District, Thirdly: Part dedicated road  
on Plan LMP 32970.  
PID 013-215-051  
Section 341(2)(b)
- Civic Address: 6306 - 152 Street  
Owned By: Sullivan Amateur Athletic and Community Association  
(Incorporated Society No. S-1700)  
Folio No. 6113-97104-1/Map 074  
Applicant's Name: **Sullivan Community Hall**

- (53) Land and improvements legally described as  
Parcel B, Plan 4734, NW ¼, Section 11, Township 2, New Westminster District,  
except firstly: Parcel 4 (By-law Plan 62479); Secondly: Part Dedicated Road on  
Plan LMP32945  
PID 002-228-238  
Section 341(2)(c), (i) & (n)
- Civic Address: 6330 - 152 Street  
Owned by: City of Surrey  
Folio No. 6113-91002-7/Map 074  
Applicant's Name: **Fraser Valley Heritage Railway Society**
- (54) Land and improvements on land legally described as  
Lot 3 Except: Firstly: The Easterly 400 Feet; Secondly: Part Subdivided by  
Plan 67299; Section 8, Township 8, New Westminster District, Plan 3612.  
PID 002-370-816  
Section 341(2)(b) & (n)
- Civic Address: 17679 - 60 Avenue  
Owned By: City of Surrey  
Folio No. 8083-02005-9/Map 077  
Applicant's Name: **Lower Fraser Valley Exhibition Association**
- (55) Land and improvements on land legally described as  
Lot 19, Section 8, Township 8, New Westminster District, Plan 4506.  
PID 011-105-275  
Section 341(2)(b) & (n)
- Civic Address: 17890 - 62 Avenue  
Owned By: City of Surrey  
Folio No. 8083-18002-6/Map 077  
Applicant's Name: **Lower Fraser Valley Exhibition Association**
- (56) Land and improvements on land legally described as  
Lot 20, Section 8, Township 8, New Westminster District, Plan 4506.  
PID 011-105-321  
Section 341(2)(b) & (n)
- Civic Address: 17890 - 62 Avenue  
Owned By: City of Surrey  
Folio No. 8083-18002-6/Map 077  
Applicant's Name: **Lower Fraser Valley Exhibition Association**

- (57) Land and improvements on land legally described as  
Lot "A", Section 8, Township 8, New Westminster District, Plan 9228.  
PID 011-418-320  
Section 341(2)(b) & (n)
- Civic Address: 17750 - 62 Avenue  
Owned By: City of Surrey  
Folio No. 8083-90002-3/Map 077  
Applicant's Name: **Lower Fraser Valley Exhibition Association**
- (58) That portion of land and improvements on land legally described as  
Strata Lot 71, Section 8, Township 8, New Westminster District, Strata Plan  
NW183 together with an interest in the common property in proportion to the unit  
entitlement of the Strata Lot as shown on Form 1.  
PID 001-179-993  
Section 341(2)(c)
- Civic Address: #71, 17712 – 60 Avenue  
Owned by: **OPTIONS: Services to Communities Society**  
(Incorporated Society No. 10398S) (Registered Charity No. 0493247-0927)  
Folio No. 8082-98271-8/Map 077  
Applicant's Name: **OPTIONS: Services to Communities Society**
- (59) Land and improvements on land legally described as  
Lot 23, Section 5, Township 8, New Westminster District, Plan 46717.  
PID 006-071-481  
Section 341(2)(c)
- Civic Address: 17949 Roan Place  
Owned By: The Surrey Association for the Mentally Handicapped  
(Incorporated Society No. S-6305)  
Folio No. 8053-22002-2/Map 087  
Applicant's Name: **The Surrey Association for the Mentally Handicapped**
- (60) Land and improvements on land legally described as  
Lot 18, District Lot 165, Group 2, New Westminster District, Plan 17141.  
PID 010-275-851  
Section 341(2)(c)
- Civic Address: 14718 Winter Crescent  
Owned By: Peace Arch Community Services Society  
(Incorporated Society No. S-16775)  
Folio No. 5700-17028-0/Map 103  
Applicant's Name: **Peace Arch Community Services Society**



- (61) Land and improvements on land legally described as Lot 2, Section 26, Township 1, New Westminster District, LMP 47440 Except: less 2,000 square feet of the building leased to a private contractor.  
PID 024-860-671  
Section 341(2)(g)

Civic Address 3288 - 156A Street  
Owned by Morgan Place Holdings  
(Community Care Facility License No. 0982965)  
Folio No. 5261-01010-X/Map 104  
Applicant's Name: **Morgan Place**

- (62) Land and improvements on land legally described as Lot 1, Except: Firstly: Parcel "A" (Explanatory Plan 9870), Secondly: Parcel "D" (By-law Plan 61031), District Lot 244, Group 2, New Westminster District Plan 6233  
PID 011-184-604  
Section 341(2)(c)

Use: Rosemary Heights Retreat Centre (Two buildings constantly used as retreat houses and by religious schools and organizations.)

Civic Address: 3690 - 152 Street  
Owned By: The Roman Catholic Archbishop of Vancouver  
Folio No. 5700-00032-5/Map 104  
Name: **Rosemary Heights Retreat Centre**

- (63) Land and improvements on land legally described as Lot A, Section 19, Township 1, New Westminster District, Plan 71424.  
PID 003-739-872  
Section 341 (2)(c)

Civic Address: 12698 - 25 Avenue  
Owned By: Semiahmoo House Society (Incorporated Society No. S-14923) (Registered Charity No. 0629659-0227)  
Folio No. 5191-90011-X/Map 104  
Applicant's Name: **The Semiahmoo House Society**

- (64) That portion of land and improvements on land legally described as Lot 231 and Lot 491, Group 2, New Westminster District, and shown hatched on the plan attached hereto.  
Section 341(2)(b) & (n)

Civic Address: 3136 and 3138 McBride Avenue  
Owned By: City of Surrey  
Folio No. 5700-97168-9 & 5700-97166-5/Map 110  
Applicant's Name: **Crescent Beach Swimming Club**  
(Incorporated Society No. S-4294)

- (65) Land and improvements on land legally described as  
Lot "E", District Lot 52, Group 2, New Westminster District, Plan 3675.  
PID 009-102-507  
Section 341(2)(c)
- Civic Address: 2916 McBride Avenue  
Owned By: Association of Neighbourhood Houses of Greater Vancouver  
(Incorporated Society No. S-36)  
Folio No. 5700-94002-4/Map 110  
Applicant's Name: **Crescent Beach Community Services**
- (66) That portion of land and improvements on land legally described as  
Block "G", District 52, Group 2, New Westminster District, Plan 6706,  
and shown hatched on the plan attached hereto.  
PID 011-040-971  
Section 341(2)(c)
- Civic Address: 12210 Agar Street  
Owned By: The Association of Neighbourhood Houses of Greater Vancouver  
(Incorporated Society No. S-36)  
Folio No. 5700-95102-2/Map 110  
Applicant's Name: **Crescent Beach Community Services**
- (67) Land and improvements on land legally described as  
Lot 2, Section 20, Township 1, New Westminster District, Plan 73190.  
PID 005-511-542  
Section 341(2)(c)
- Civic Address: 12969 Crescent Road  
Owned By: The Faith Mission (In Canada)  
(Incorporated Extra-Provincial Society No. 6283)  
Folio No. 5203-01001-8/Map 111  
Applicant's Name: **Faith Mission Conference Centre**
- (68) Strata Lot 1, Section 23, Township 1, New Westminster District, Strata Plan  
NW3287, Together with an interest in the common property in proportion to the  
unit entitlement of the Strata Lot as shown on Form 1.  
PID 016-257-537  
Section 341(2)(c)
- Civic Address: #101, 15585 - 24 Avenue  
Owned By: The Semiahmoo Foundation (Incorporated Society No. S-26008)  
(Registered Charity No. 0870451-3)  
Folio No. 5230-98098-9/Map 114  
Applicant's Name: **The Semiahmoo Foundation**

- (69) Strata Lot 13, Section 23, Township 1, New Westminster District, Strata Plan NW3287, together with an interest in the common property in proportion to the unit entitlement of the Strata Lot as shown on Form 1.  
PID 016-257-715  
Section 341(2)(c)

Civic Address: #201, 15585 - 24th Avenue  
Owned By: The Semiahmoo Foundation (Incorporated Society No. S-26008)  
Registered Charity No. 0870451-3)  
Folio No. 5230-98110-6/Map 114  
Applicant's Name: **The Semiahmoo Foundation**

- (70) Strata Lot 14, Section 23, Township 1, New Westminster District, Strata Plan NW3287, Together with an interest in the common property in proportion to the unit entitlement of the Strata Lot as shown on Form 1.  
PID 016-257-723  
Section 341(2)(c)

Civic Address: #202, 15585 - 24th Avenue  
Owned By: The Semiahmoo Foundation (Incorporated Society No. S-26008)  
(Registered Charity No. 0870451-3)  
Folio No. 5230-98111-8/Map 14  
Applicant's Name: **The Semiahmoo Foundation**

- (71) Land and improvements on land legally described as  
SE Section 21, Township 7, Part E 1/2 of SE 1/4, Leased Portion Only,  
New Westminster District.  
PID 013-243-888  
Section 341(2)(b) & (n)

Civic Address: 2775 - 192 Street  
Owned By: City of Surrey  
Folio No. 7211-97103-4/Map 118  
Applicant's Name: **Lower Mainland German Shepherd Dog Club**  
(Incorporated Society No. S-14435)

- (72) Land and improvements on land legally described as  
Lot 1, Section 18, Township 1, New Westminster District, Plan 70339.  
PID 002-268-256  
Section 341(2)(c)

Civic Address: 12614 - 22 Avenue  
Owned By: Peace Arch Community Services Society (Incorporated Society  
No. S-16775)  
Folio No. 5184-00007-0/Map 120  
Applicant's Name: **Peace Arch Community Services Society**

- (73) Strata Lots 1, 4, 5, 6, 8, 9, 10, 12, 13, 14, 15, 18, 19, 20, 21, 22, 26, 27, 44, 61, 62, 85, 86, 88, 89, 90, 91, 92, 95, 102, 108, 109, 113, 114, 115 and 116 all of Section 16, Township 1, New Westminster District, Strata Plan LMP 3250, together with an interest in the Common Property in proportion to the unit entitlement of the Strata Lot as shown on Form 1.

|                                       |               |
|---------------------------------------|---------------|
| PID 024-169-714 (Lot 1 - Unit #32)    | #5162-98200-3 |
| PID 024-169-757 (Lot 4 - Unit #30)    | #5162-98203-9 |
| PID 024-169-765 (Lot 5 - Unit #28)    | #5162-98204-0 |
| PID 024-169-935 (Lot 6 - Unit #29)    | #5162-98205-2 |
| PID 024-169-951 (Lot 8 - Unit #26)    | #5162-98207-6 |
| PID 024-169-960 (Lot 9 - Unit #24)    | #5162-98208-8 |
| PID 024-169-978 (Lot 10 - Unit #25)   | #5162-98209-X |
| PID 024-169-994 (Lot 12 - Unit #22)   | #5162-98211-8 |
| PID 024-170-003 (Lot 13 - Unit #20)   | #5162-98212-X |
| PID 024-170-011 (Lot 14 - Unit #21)   | #5162-98213-1 |
| PID 024-170-020 (Lot 15 - Unit #19)   | #5162-98214-3 |
| PID 024-170-054 (Lot 18 - Unit #17)   | #5162-98217-9 |
| PID 024-170-062 (Lot 19 - Unit #15)   | #5162-98218-0 |
| PID 024-170-089 (Lot 20 - Unit #14)   | #5162-98219-2 |
| PID 024-170-097 (Lot 21 - Unit #12)   | #5162-98220-9 |
| PID 024-170-101 (Lot 22 - Unit #13)   | #5162-98221-0 |
| PID 024-170-151 (Lot 26 - Unit #07)   | #5162-98225-8 |
| PID 024-170-160 (Lot 27 - Unit #05)   | #5162-98226-X |
| PID 024-172-791 (Lot 44 - Unit #107)  | #5162-98243-X |
| PID 024-170-798 (Lot 61 - Unit #129)  | #5162-98260-X |
| PID 024-172-979 (Lot 62 - Unit #131)  | #5162-98261-1 |
| PID 024-171-034 (Lot 85 - Unit #34)   | #5162-98284-2 |
| PID-024-171-042 (Lot 86 - Unit #36)   | #5162-98285-4 |
| PID 024-171-069 (Lot 88 - Unit #38)   | #5162-98287-8 |
| PID 024-171-077 (Lot 89 - Unit #39)   | #5162-98288-X |
| PID 024-171-085 (Lot 90 - Unit #40)   | #5162-98289-1 |
| PID 024-171-093 (Lot 91 - Unit #41)   | #5162-98290-8 |
| PID-024-171-107 (Lot 92 - Unit #42)   | #5162-98291-X |
| PID-024-171-131 (Lot 95 - Unit #34)   | #5162-98294-5 |
| PID-024-171-204 (Lot 102 - Unit #141) | #5162-98301-9 |
| PID-024-171-263 (Lot 108 - Unit #219) | #5162-98307-X |
| PID-024-171-271 (Lot 109 - Unit #221) | #5162-98308-1 |
| PID-024-171-310 (Lot 113 - Unit #226) | #5162-98312-3 |
| PID-024-171-328 (Lot 114 - Unit #222) | #5162-98313-5 |
| PID-024-171-336 (Lot 115 - Unit #220) | #5162-98314-7 |
| PID-024-171-344 (Lot 116 - Unit #35)  | #5162-98315-9 |

(consists of dining room,  
library, nursing station, to  
facilitate the care)

Section 341(2)(g)

Civic Address: 1653 - 140 Street  
Owned By: HRC Care Society (Incorporated Society No. S31424)  
(Community Care Facility License No. 0920097)/Map 122  
Applicant's Name: **Westminster House**

- (74) Land and improvements on land legally described as  
Lot 556, Section 16, Township 1, New Westminster District, Plan 66018.  
PID 011-097-679  
Section 341(2)(c)

Civic Address: 14278 - 20 Avenue  
Owned By: Semiahmoo House Society (Incorporated Society No. S-14923)  
(Registered Charity No. 0629659-0227)  
Folio No. 5161-52009-7/Map 122  
Applicant's Name: **The Semiahmoo House Society**

- (75) Land and improvements on land legally described as  
Lot 209, Section 15, Township 1, New Westminster District, Plan 54061.  
PID 005-226-040  
Section 341(2)(c)

Civic Address: 14482 - 16A Avenue  
Owned By: Atira Women's Resource Society (Incorporated Society  
No. S-17967) (Registered Charity No. 10673-6101)  
Folio No. 5152-85802-2/Map 123  
Applicant's Name: **Atira Women's Resource Society**

- (76) That portion of land and improvements on land legally described as  
Lot 3, Except: Part subdivided by Plan LMP 36078, Section 15, Township 1,  
New Westminster District, Plan 83184,  
and shown hatched on the plan attached hereto.  
PID 015-151-077  
Section 341(2)(c) & (n)

Civic Address: 2199 - 148th Street  
Owned By: City of Surrey  
Folio No. 5153-02003-4/Map 123  
Applicant's Name: **The Pamela Cameron Foundation**  
(The Forever Garden)  
(Incorporated Society No. S-33371)

- (77) That portion of land and improvements legally described as Lot 3, Section 15, Township 1, New Westminster District, Plan 83184 and shown hatched on the plan attached hereto.  
PID 015-151-077  
Section 341(2)(b) & (n)
- Civic Address: 2201 -148 Street  
Owned By: City of Surrey  
Folio No. 5153-02002-2/Map 123  
Applicant's Name: **British Columbia Amateur Softball Association (Softball City)** (Incorporated Society No. S-3741)
- (78) That 17,030 sq. ft. portion of land and improvements on land legally described as Lot "A", Section 14, Township 1, New Westminster District, Plan 11601, and shown hatched on the plan attached hereto.  
PID 014-364-140  
Section 341(2)(c) and (m)
- Civic Address: 2124 - 154 Street  
Owned By: The Board of School Trustees - School District No. 36 (Surrey)  
Folio No. 5140-90003-8/Map 124  
Applicant's Name: **Peninsula Child Care Society** (Incorporated Society No. S32275)
- (79) Land and improvements on land legally described as Lot 1, Section 14, Township 1, New Westminster District, Plan 71395  
PID 003-676-404  
Section 341(2)(c)
- Civic Address: 15318 - 20th Avenue  
Owned By: South Surrey/White Rock Women's Place Association (Incorporated Society No. S-14544)  
Folio No. 5142-00043-2/Map 124  
Applicant's Name: **South Surrey/White Rock Women's Place**
- (80) Land and improvements on land legally described as Parcel "One", Section 14, Township 1, New Westminster District, Reference Plan 73654.  
PID 006-241-000  
Section 341(2)(g)
- Civic Address: 15441 - 16 Avenue  
Owned By: Peace Portal Lodge Limited (Co. Incorporated Society No. 306234) (Community Care Facility Licence No. 0982672)  
Folio No. 5142-00045-6/Map 124  
Applicant's Name: **Peace Portal Lodge**

- (81) Land and improvements on land legally described as  
Lot 302, Section 14, Township 1, New Westminster District, Plan 63038.  
PID 003-198-804  
Section 341(2)(c)

Civic Address: 2266 - 154 Street  
Owned By: Surrey & White Rock Home Support Association  
(Incorporated Society No. S11884)  
(Registered Charity No. 0530428-927)  
Folio No. 5140-89953-X/Map 124  
Applicant's Name: **Yvonne Jensen Home for Seniors**

- (82) Land and improvements on land legally described as  
Lot 1, Section 14, Township 1, New Westminster District, Plan 20734.  
PID 007-617-461  
Section 341(2)(c)

Civic Address: 1951 King George Highway  
Owned By: Peace Arch Community Services Society (Incorporated  
Society No. S-16775)  
Folio No. 5141-00018-7/Map 124  
Applicant's Name: **Peace Arch Community Services Society**

- (83) Land and improvements on land legally described as  
Parcel 1, Section 14, Township 1, NW District, Plan LMP 52718  
PID 025-259-253  
Section 341(2)(c)

\*Civic Address: 15310 - 24 Avenue  
Owned By: The Semiahmoo Foundation (Incorporated Society No. S-26008)  
(Registered Charity No. 0870451-30)  
Folio No. 5140-27011-0/Map 124  
Applicant's Name: **The Semiahmoo Foundation**

\*Note: Facility under construction, occupancy December 2002.

- (84) Land and improvements on land legally described as  
Lot 6, Section 18, Township 7, New Westminster District, Plan 16389  
PID 007-539-894  
Section 341(2)(c)

Civic Address: 17165 - 20 Avenue  
Owned By: Semiahmoo House Society (Incorporated Society No. S-14923)  
Registered Charity No. 0629659-0227)  
Folio No. 7183-05002-6/Map 126  
Applicant's Name: **The Semiahmoo House Society**

- (85) That portion of land and improvements on land legally described as Fractional North East Quarter (NE 1/4), Section 7, Township 1, Except: Firstly: Part on Statutory Right-of-Way 10769, Secondly: Part subdivided by Plan 2834, New Westminster District and shown hatched on plan attached hereto.  
PID 013-191-560  
Section 341(2)(b) & (c)

Civic Address: 1367 - 128 Street  
Owned By: Metropolitan Council of the United Church of Canada  
of the Lower Mainland of B.C. Conference  
Folio No. 5074-97102-0/Map 130  
Applicant's Name: **Camp Kwomais**

- (86) Land and improvements on land legally described as Lot "C" (BF 437078), Block 12, Section 7, Township 1, New Westminster District, Plan 2834.  
PID 017-999-481  
Section 341(2)(b)

Civic Address: 1577 - 128 Street  
Owned By: Ocean Park Community Association  
(Incorporated Society No. S-1476)  
Folio No. 5074-92001-2/Map 130  
Applicant's Name: **Ocean Park Community Hall**

- (87) Land and improvements on land legally described as Lot 4, Section 12, Township 1, New Westminster District, Plan 9013.  
PID 011-111-666  
Section 341(2)(c)

Civic Address: 1290 - 160 Street  
Owned By: Peace Arch Community Services Society (Incorporated Society  
No. S16775)  
Folio No. 5123-03006-2/Map 135  
Applicant's Name: **Peace Arch Community Services Society**

- (88) Land and improvements on land legally described as Lot 54, Section 12, Township 1, New Westminster District, Plan 10384.  
PID 009-313-125  
Section 341(2)(c)

Civic Address: 16230 - 16 Avenue  
Owned By: Semiahmoo House Society (Incorporated Society No. S-14923)  
Registered Charity No. 0629659-0227)  
Folio No. 5123-51502-1/Map 135  
Applicant's Name: **The Semiahmoo House Society**



- (89) Strata Lots 79, 80, 81, 82, 83, 84, 85, 86, 87, 88, 89, 90, 91, 92, 93, 94, 95, 96, 97, 98, 100, 101, 102, 103, 104, 105, 106, 107, 108, 109, 110, 118, 119, 120, 121, 122, 123, 124, 125, 126, 127, 128, 129, 130, 131, 132, 133, 134, 135, 136, 137, 138, 139, 140, 141, 142, 143, 144, 145, 146, 147, 148, 149, 150, 151, 152, 153, 154, 155, 156, 157 and 158, all of Section 12, Township 1, New Westminster District, Strata Plan LMS 2925 together with an interest in the common property in proportion to the unit entitlement of the strata lot as shown on Form 1.

|  |               |
|--|---------------|
| PID 023-880-155 (Lot 79 - Unit #3364)  | #5121-98079-6 |
| PID 023-880-163 (Lot 80 - Unit #3366)  | #5121-98080-2 |
| PID 023-880-171 (Lot 81 - Unit #3368)  | #5121-98081-4 |
| PID 023-880-180 (Lot 82 - Unit #3370)  | #5121-98082-6 |
| PID 023-880-198 (Lot 83 - Unit #3372)  | #5121-98083-8 |
| PID 023-880-201 (Lot 84 - Unit #3373)  | #5121-98084-X |
| PID 023-880-210 (Lot 85 - Unit #3374)  | #5121-98085-1 |
| PID 023-880-228 (Lot 86 - Unit #3302)  | #5121-98086-3 |
| PID 023-880-236 (Lot 87 - Unit #3304)  | #5121-98087-5 |
| PID 023-880-244 (Lot 88 - Unit #3306)  | #5121-98088-7 |
| PID 023-880-252 (Lot 89 - Unit #3308)  | #5121-98089-9 |
| PID 023-880-261 (Lot 90 - Unit #3310)  | #5121-98090-5 |
| PID 023-880-279 (Lot 91 - Unit #3312)  | #5121-98091-7 |
| PID 023-880-287 (Lot 92 - Unit #3314)  | #5121-98092-9 |
| PID 023-880-295 (Lot 93 - Unit #3316)  | #5121-98093-0 |
| PID 023-880-309 (Lot 94 - Unit #3318)  | #5121-98094-2 |
| PID 023-880-317 (Lot 95 - Unit #3319)  | #5121-98095-4 |
| PID 023-880-325 (Lot 96 - Unit #3320)  | #5121-98096-6 |
| PID 023-880-333 (Lot 97 - Unit #3321)  | #5121-98097-8 |
| PID 023-880-341 (Lot 98 - Unit #3322)  | #5121-98098-X |
| PID-023-880-368 (Lot 100 - Unit #3324) | #5121-98100-4 |
| PID-023-880-384 (Lot 101 - Unit #3326) | #5121-98101-6 |
| PID-023-880-392 (Lot 102 - Unit #3328) | #5121-98102-8 |
| PID-023-880-406 (Lot 103 - Unit #3330) | #5121-98103-X |
| PID-023-880-414 (Lot 104 - Unit #3332) | #5121-98104-1 |
| PID-023-880-422 (Lot 105 - Unit #3334) | #5121-98105-3 |
| PID-023-880-431 (Lot 106 - Unit #3336) | #5121-98106-5 |
| PID-023-880-449 (Lot 107 - Unit #3338) | #5121-98107-7 |
| PID-023-880-457 (Lot 108 - Unit #3340) | #5121-98108-9 |
| PID-023-880-465 (Lot 109 - Unit #3342) | #5121-98109-0 |
| PID-023-880-473 (Lot 110 - Unit #3344) | #5121-98110-7 |
| PID-023-880-601 (Lot 118 - Unit #3347) | #5121-98118-1 |
| PID-023-880-694 (Lot 119 - Unit #3348) | #5121-98119-3 |
| PID-023-880-716 (Lot 120 - Unit #3349) | #5121-98120-X |
| PID-023-880-741 (Lot 121 - Unit #3350) | #5121-98121-1 |
| PID-023-880-767 (Lot 122 - Unit #3352) | #5121-98122-3 |
| PID-023-880-775 (Lot 123 - Unit #3354) | #5121-98123-5 |
| PID-023-880-791 (Lot 124 - Unit #3356) | #5121-98124-7 |
| PID-023-880-805 (Lot 125 - Unit #3358) | #5121-98125-9 |
| PID-023-880-813 (Lot 126 - Unit #3360) | #5121-98126-0 |
| PID-023-880-821 (Lot 127 - Unit #3362) | #5121-98127-2 |
| PID-023-880-830 (Lot 128 - Unit #3363) | #5121-98128-4 |

|  |               |
|--|---------------|
| PID-023-880-848 (Lot 129 - Unit #3361) | #5121-98129-6 |
| PID-023-880-856 (Lot 130 - Unit #3359) | #5121-98130-2 |
| PID-023-880-864 (Lot 131 - Unit #3357) | #5121-98131-4 |
| PID-023-880-872 (Lot 132 - Unit #3355) | #5121-98132-6 |
| PID-023-880-881 (Lot 133 - Unit #3353) | #5121-98133-8 |
| PID-023-880-899 (Lot 134 - Unit #3351) | #5121-98134-X |
| PID-023-880-902 (Lot 135 - Unit #3345) | #5121-98135-1 |
| PID-023-880-911 (Lot 136 - Unit #3343) | #5121-98136-3 |
| PID-023-880-929 (Lot 137 - Unit #3341) | #5121-98137-5 |
| PID-023-880-937 (Lot 138 - Unit #3339) | #5121-98138-7 |
| PID-023-880-945 (Lot 139 - Unit #3337) | #5121-98139-9 |
| PID-023-880-953 (Lot 140 - Unit #3335) | #5121-98140-5 |
| PID-023-880-961 (Lot 141 - Unit #3333) | #5121-98141-7 |
| PID-023-880-970 (Lot 142 - Unit #3331) | #5121-98142-9 |
| PID-023-880-988 (Lot 143 - Unit #3329) | #5121-98143-0 |
| PID-023-880-996 (Lot 144 - Unit #3327) | #5121-98144-2 |
| PID-023-881-003 (Lot 145 - Unit #3325) | #5121-98145-4 |
| PID-023-881-011 (Lot 146 - Unit #3317) | #5121-98146-6 |
| PID-023-881-020 (Lot 147 - Unit #3315) | #5121-98147-8 |
| PID-023-881-038 (Lot 148 - Unit #3313) | #5121-98148-X |
| PID-023-881-046 (Lot 149 - Unit #3311) | #5121-98149-1 |
| PID-023-881-054 (Lot 150 - Unit #3309) | #5121-98150-8 |
| PID-023-881-062 (Lot 151 - Unit #3307) | #5121-98151-X |
| PID-023-881-071 (Lot 152 - Unit #3305) | #5121-98152-1 |
| PID-023-881-089 (Lot 153 - Unit #3303) | #5121-98153-3 |
| PID-023-881-097 (Lot 154 - Unit #3301) | #5121-98154-5 |
| PID-023-881-101 (Lot 155 - Unit #3371) | #5121-98155-7 |
| PID-023-881-119 (Lot 156 - Unit #3369) | #5121-98156-9 |
| PID-023-881-127 (Lot 157 - Unit #3367) | #5121-98157-0 |
| PID-023-881-135 (Lot 158 - Unit #3365) | #5121-98158-2 |

Section 341(2)(g)

Civic Address: 1222 King George Highway  
Owned By: CPAC (Crescent Gardens) Incorporated  
(Community Care Facility License No. 0982551)/Map 135  
Applicant's Name: **Crescent Gardens.**

- (90) That portion of land and improvements on land legally described as Sections 1 and 2, Township 1, Semiahmoo Indian Reserve, NWD, and shown hatched on the plan attached hereto.  
Sections 341 (2) (b) and (c)

Civic Address: 16323 Beach Road  
Owned By: Semiahmoo Indian Band First Nation  
Folio No. 5010-97116-6/Map 145  
Applicant's Name: **Royal Canadian Legion**

3. Fifty percent (50%) of the following lands or improvements, or portion thereof, are hereby exempted from taxation for the Year 2003 in the City of Surrey pursuant to Sections 341 and 342 of the Local Government Act, R.S.B.C. 1996, Chap.323 as amended:

- (1) That portion of land and improvements on land legally described as Lot 1, Section 20, Range 2 West, New Westminster District, Plan 1587.  
PID 012-265-420  
Section 342  
  
Civic Address: 10668 – 125B Street  
Owned By: V. & A. Puchmayr  
Folio No. 2200-00010-8/Map 010  
Applicant's Name: **Creighton House**
  
- (2) That portion of land and improvements on land legally described as of the North West Quarter (NW 1/4) of Section 6, Township 2, Reference Plan 8568, New Westminster District and shown hatched on the plan attached hereto.  
PID 002-384-400  
Section 341(2)(b) & (n)  
  
Civic Address: 5435 - 123 Street  
Owned By: City of Surrey  
Folio No. 6063-97104-X/Map 080  
Applicant's Name: **Panorama Ridge Riding Club**  
(Incorporated Society No. S-11230)
  
- (3) Land and improvements on land legally described as Lot 22, Section 4, Township 8, New Westminster District, Plan 58597.  
PID 004-613-422  
Section 342  
  
Civic Address: 5418 - 184 Street  
Owned By: J. & F. McCleneghan  
Folio No. 8043-21002-0/Map 088  
Applicant's Name: **Robert Dougal MacKenzie Heritage House**
  
- (4) That portion of land and improvements on land legally described as Lot 4, Section 25, Township 1, New Westminster District, Plan 26296 and shown hatched on the plan attached hereto.  
PID 008 892 571  
Section 342  
  
Civic Address: 16520 – 40 Avenue  
Owned By: R.P. and S.S. Harrison  
Folio No. 5254-03002-1/Map 105

Applicant's Name: **Historic Collishaw Farm**

- (5) That portion of land and improvements on land legally described as Lots 231 and 491, Group 2, Plan 4302, New Westminster District and shown hatched on the plan attached hereto.  
Section 341(2)(b) & (n)

Civic Address: 3140 McBride Avenue

Owned By: City of Surrey

Folio No. 5700-97169-0/Map 110

Applicant's Name: **Surrey Sailing Club** (Incorporated Society No. 8762)

- (6) That portion of land and improvements on land legally described as Parcel "B", Explanatory Plan 12326 of Lot 3, Except: part subdivided by Plan 18260, Section 13, Township 1, New Westminster District, Plan 6519  
PID 011-203-013  
Section 341(2)(b) & (n)

Civic address: 2284 - 165 Street

Owned by: City of Surrey

Folio No. 5134-90006-6/Map 125

Applicant's Name: **Sunnyside Saddle Club**  
(Incorporated Society No. S-26846)

### **Repeal Section**

4. "Tax Exemption By-law, 2001, No. 14513" is hereby repealed.

PASSED THREE READINGS by the City Council on the 7th day of October, 2002.

RECONSIDERED AND FINALLY ADOPTED, signed by the Mayor and Clerk and sealed with the Corporate Seal on the 21st day of October, 2002.

\_\_\_\_\_MAYOR

\_\_\_\_\_CLERK

Section 341 (2)(c)  
Item No. 19

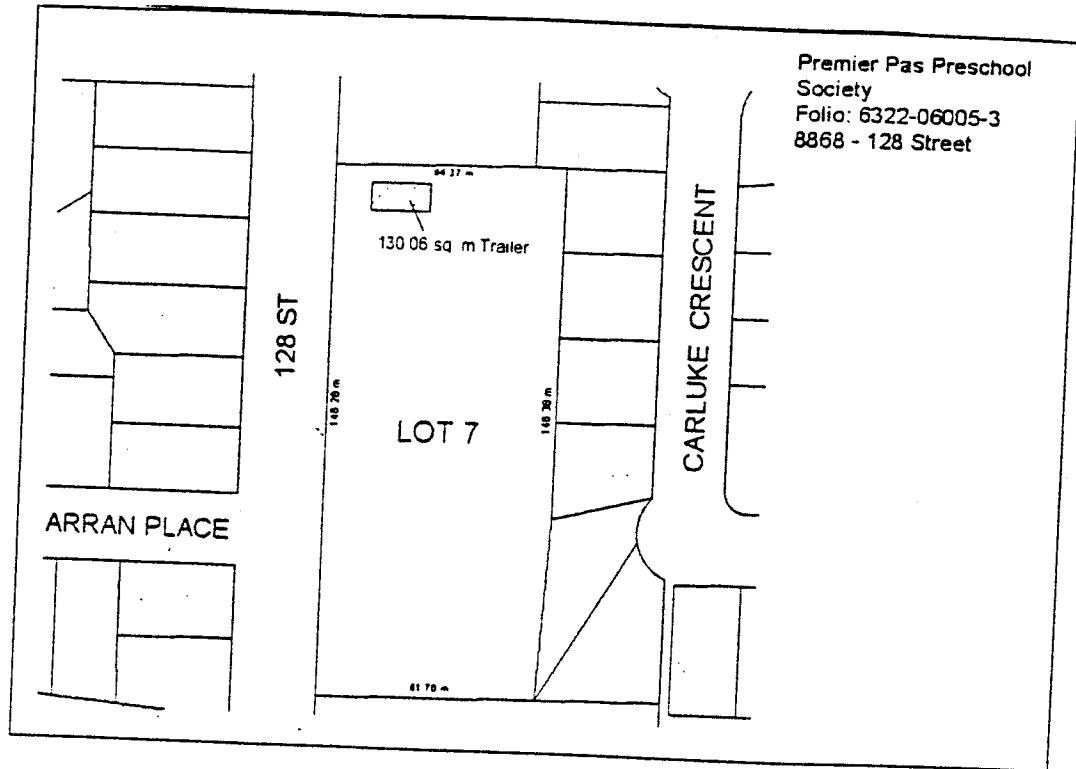

Section 341 (2)(c)  
Item No. 51

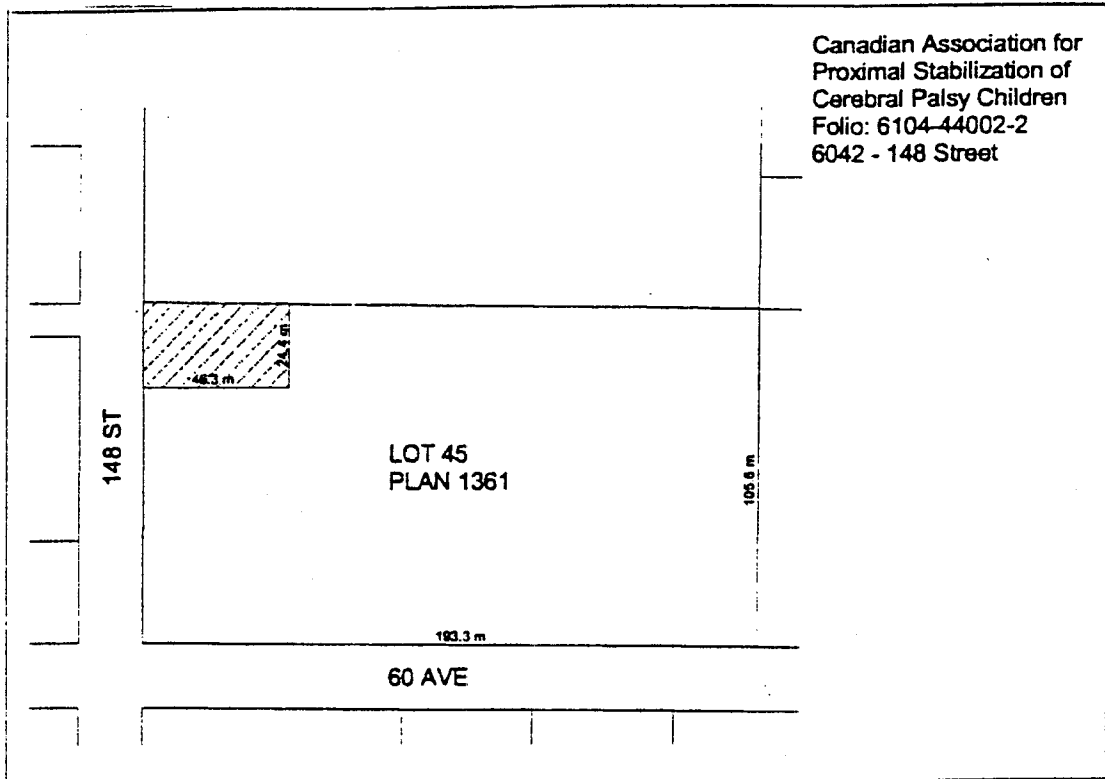

Section 341 (2)(b), (n)  
Item No. 64

Crescent Beach Swimming Club  
Folio No. 5700-97168-9 &  
5700-97166-5  
3136 and 3138 McBride Avenue

Exempt area shown hatched

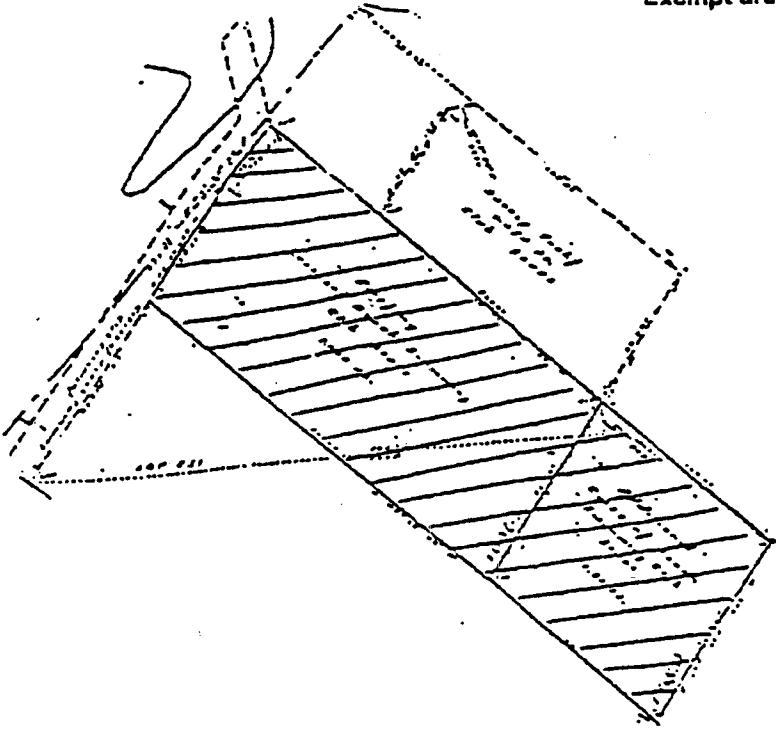

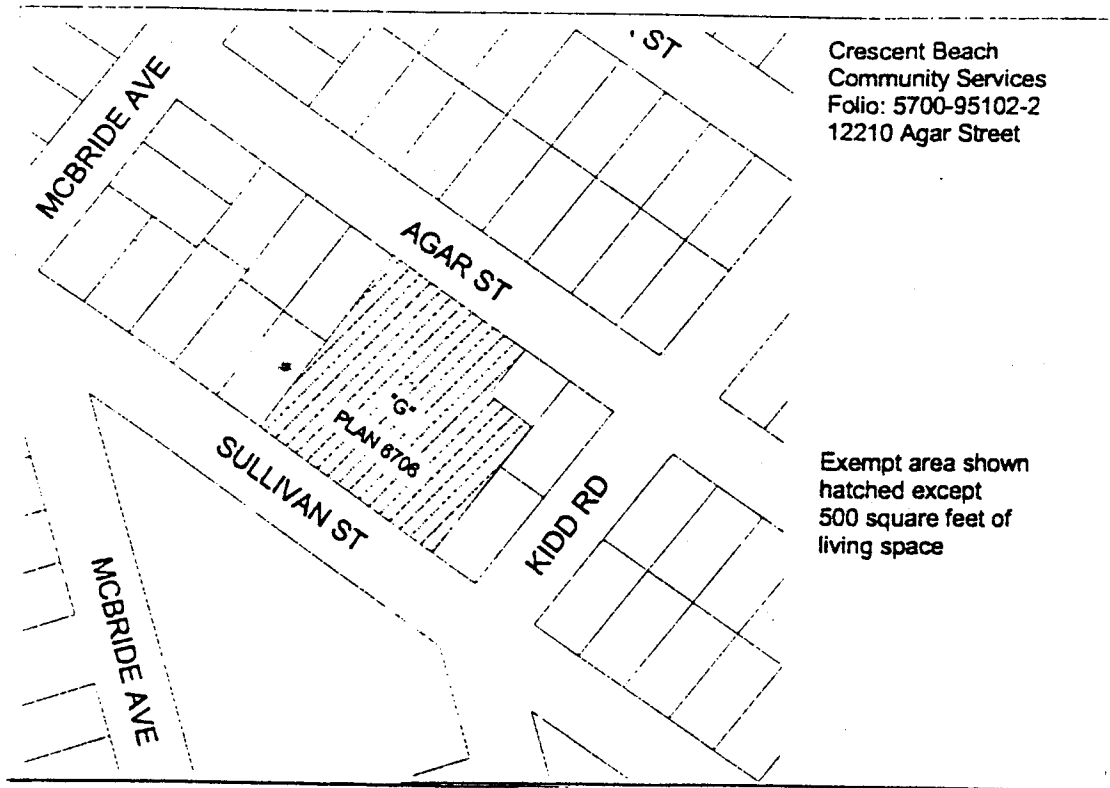

Crescent Beach  
Community Services  
Folio: 5700-95102-2  
12210 Agar Street

Exempt area shown  
hatched except  
500 square feet of  
living space



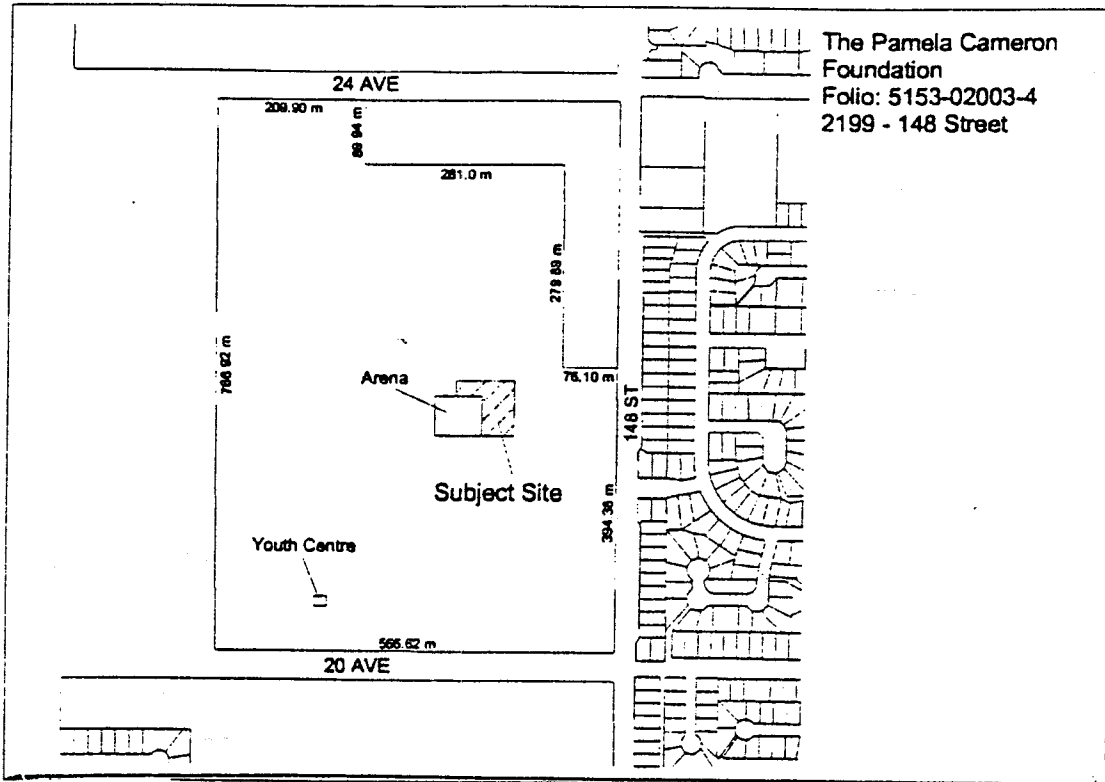

Section 341 (2)(b), (n)  
Item No. 77

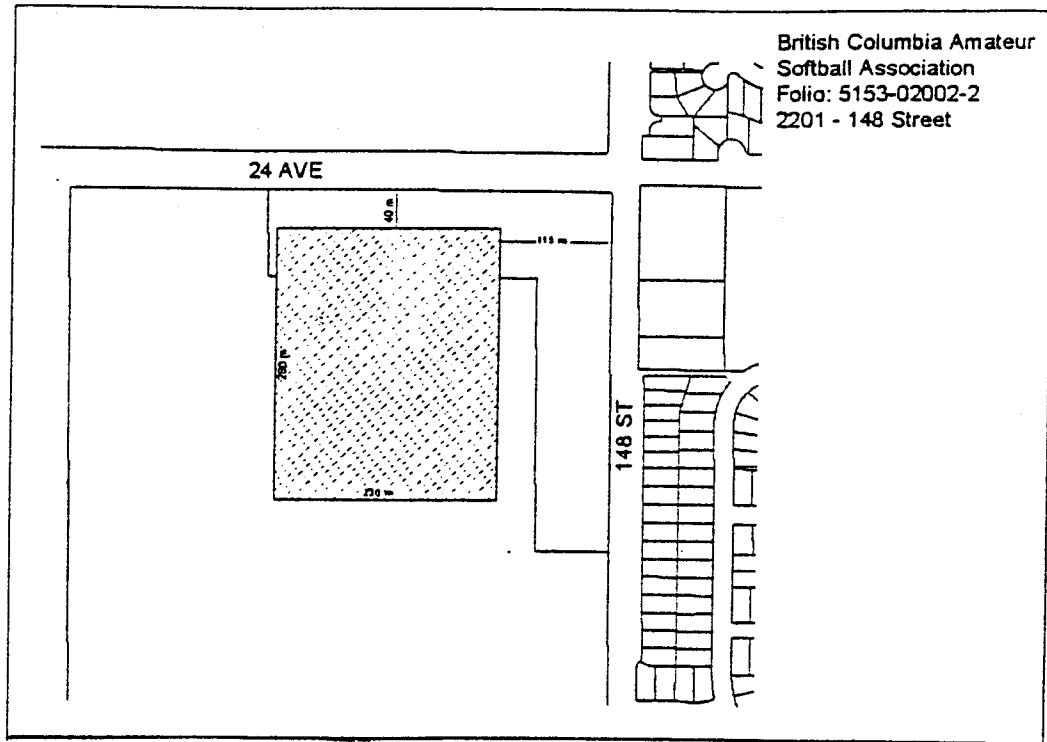

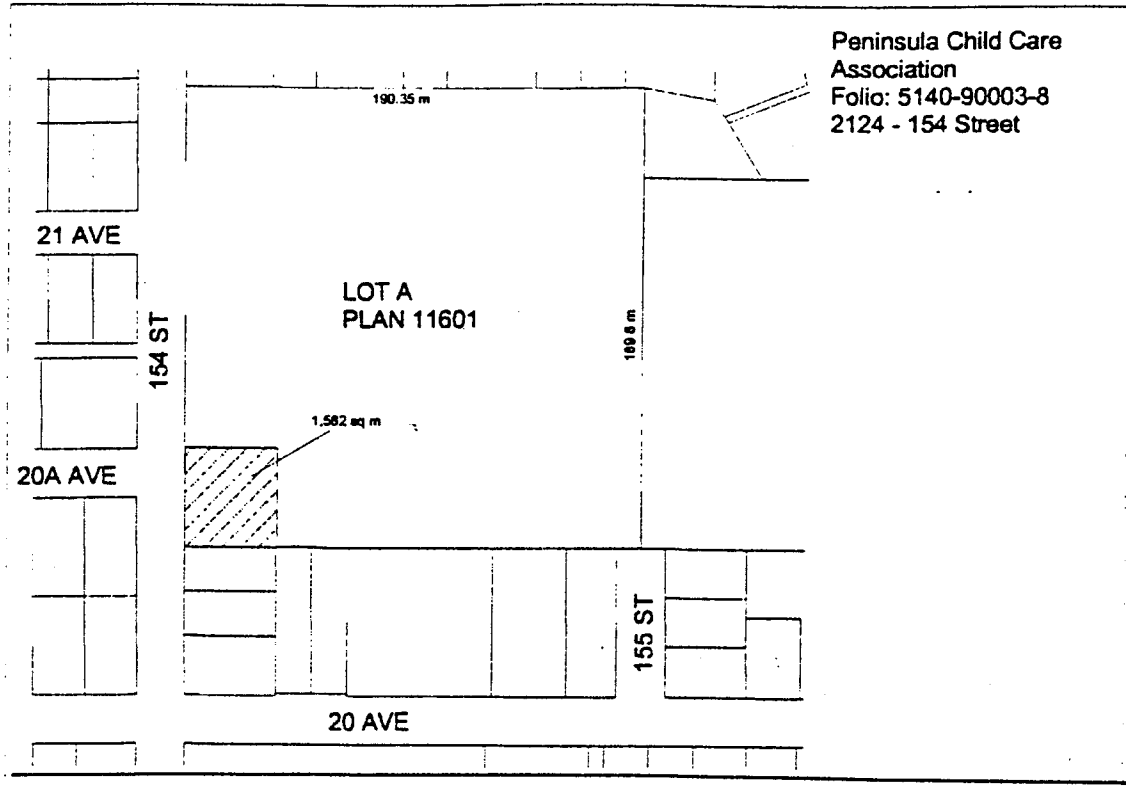

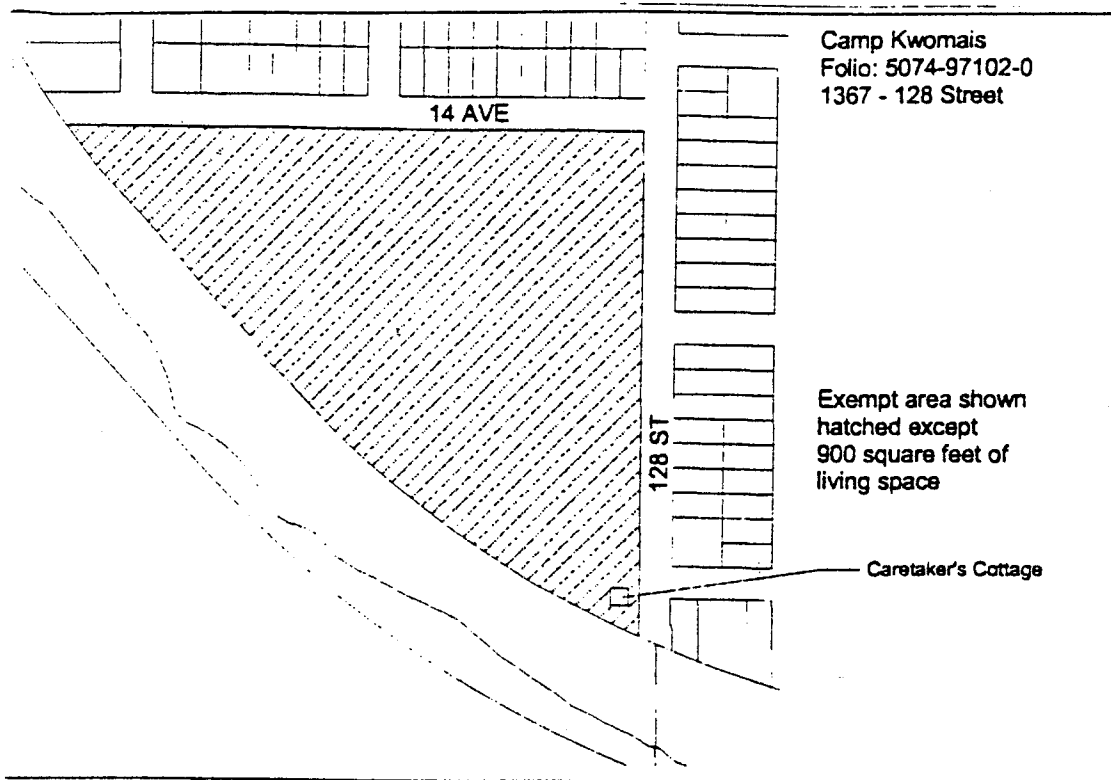

Section 341 (2)(b), (c)  
Item No. 90

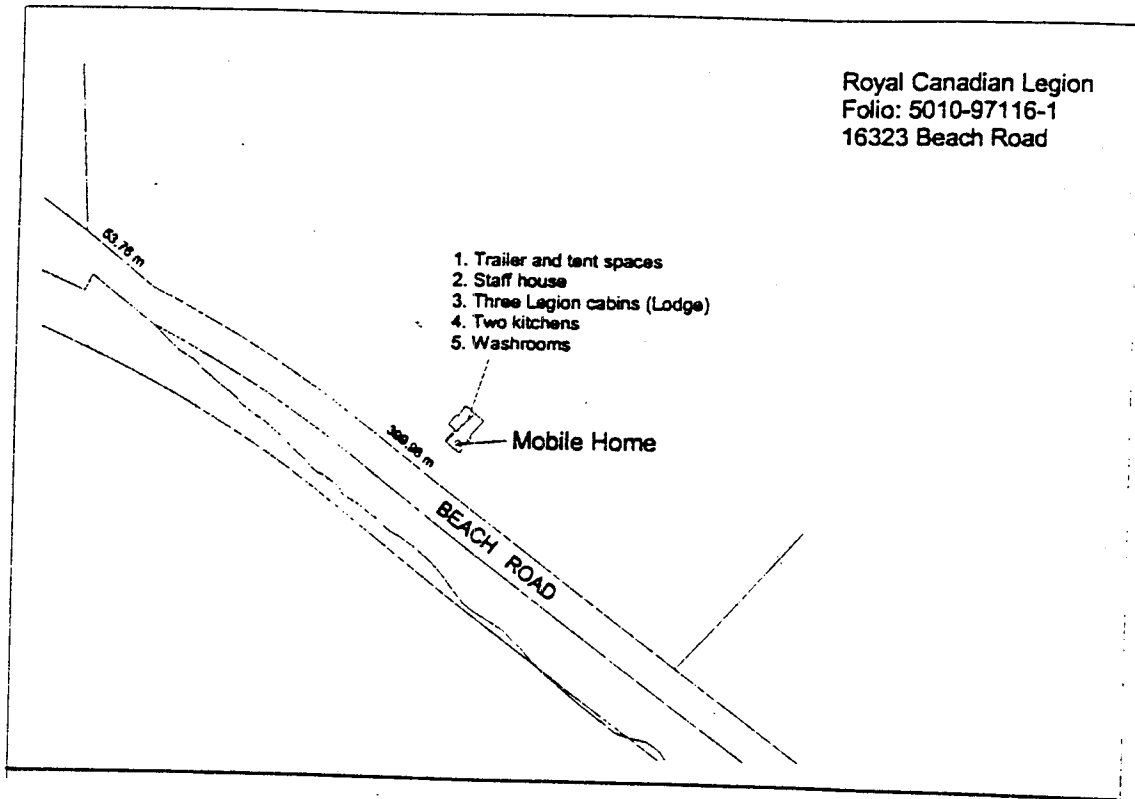

Section 341 (2)(b). (n)  
Item No. 3.(2)

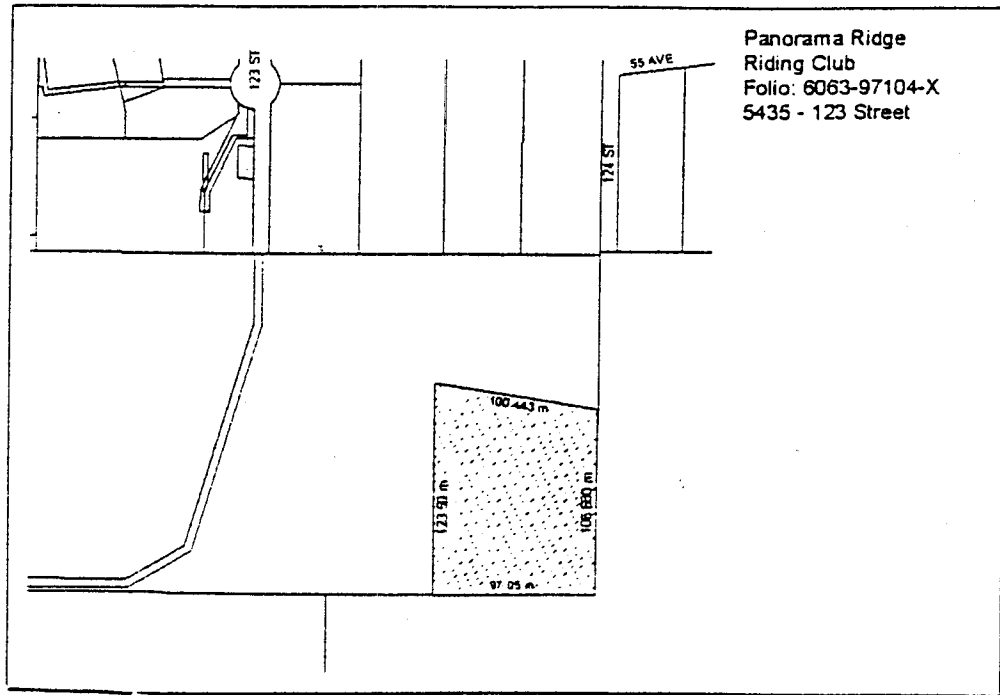

Section 342  
Item No. 3.(4)

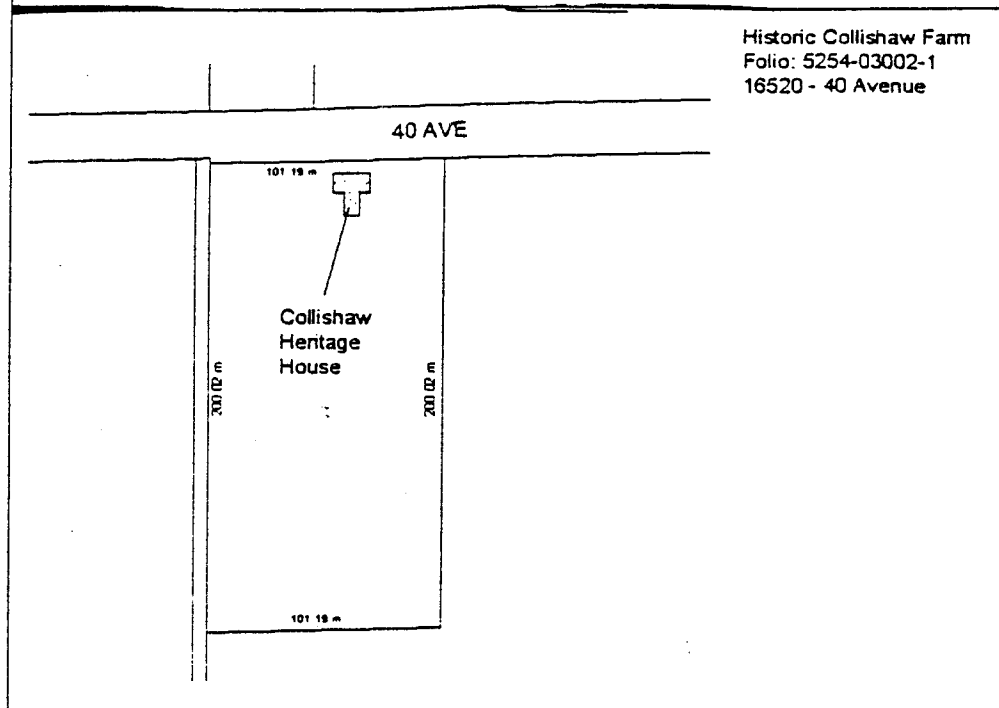

Section 341 (2)(b), (n)  
Item No. 3.(5)

