

CITY OF SURREY

BY-LAW NO. 16250

A by-law to amend the provisions of "Surrey Official
Community Plan By-law, 1996, No. 12900," as amended.

.....

The Council of the City of Surrey, in open meeting assembled, ENACTS AS FOLLOWS:

1. That portion of the map designated as Schedule A. Land Use Designation Map, Division A of "Surrey Official Community Plan By-law, 1996, No. 12900," as amended as shown outlined black on the plan attached hereto and designated as "Amendment to Schedule A, Land Use Designation Map" is hereby amended as follows:

FROM: SUBURBAN (SUB)

TO: MULTIPLE RESIDENTIAL (RM)

Parcel Identifier: 001-063-693

Lot 24 Section 23 Township 1 New Westminster District Plan 66278

(15810 - 28 Avenue)

Parcel Identifier: 001-063-677

Lot 25 Section 23 Township 1 New Westminster District Plan 66278

(15838 - 28 Avenue)

Parcel Identifier: 001-063-685

Lot 26 Section 23 Township 1 New Westminster District Plan 66278

(15870 - 28 Avenue)

Parcel Identifier: 003-858-596

North Half Legal Subdivision 8 Section 23 Township 1 Except: Firstly:
Part subdivided by Plan 8592 Secondly: Part subdivided by Plan 66278
New Westminister District

(15912 - 28 Avenue)

2. This By-law shall be cited for all purposes as "Surrey Official Community Plan By-law, 1996, No. 12900, No. 163 Amendment By-law, 2007, No. 16250."

PASSED FIRST AND SECOND READING on the 22nd day of January, 2007.

PUBLIC HEARING HELD thereon on the 12th day of February, 2007.

PASSED THIRD READING on the 12th day of February, 2007.

RECONSIDERED AND FINALLY ADOPTED, signed by the Mayor and Clerk, and sealed with the Corporate Seal on the 11th day of June, 2007.

_____ MAYOR

_____ CLERK

APPENDIX IX

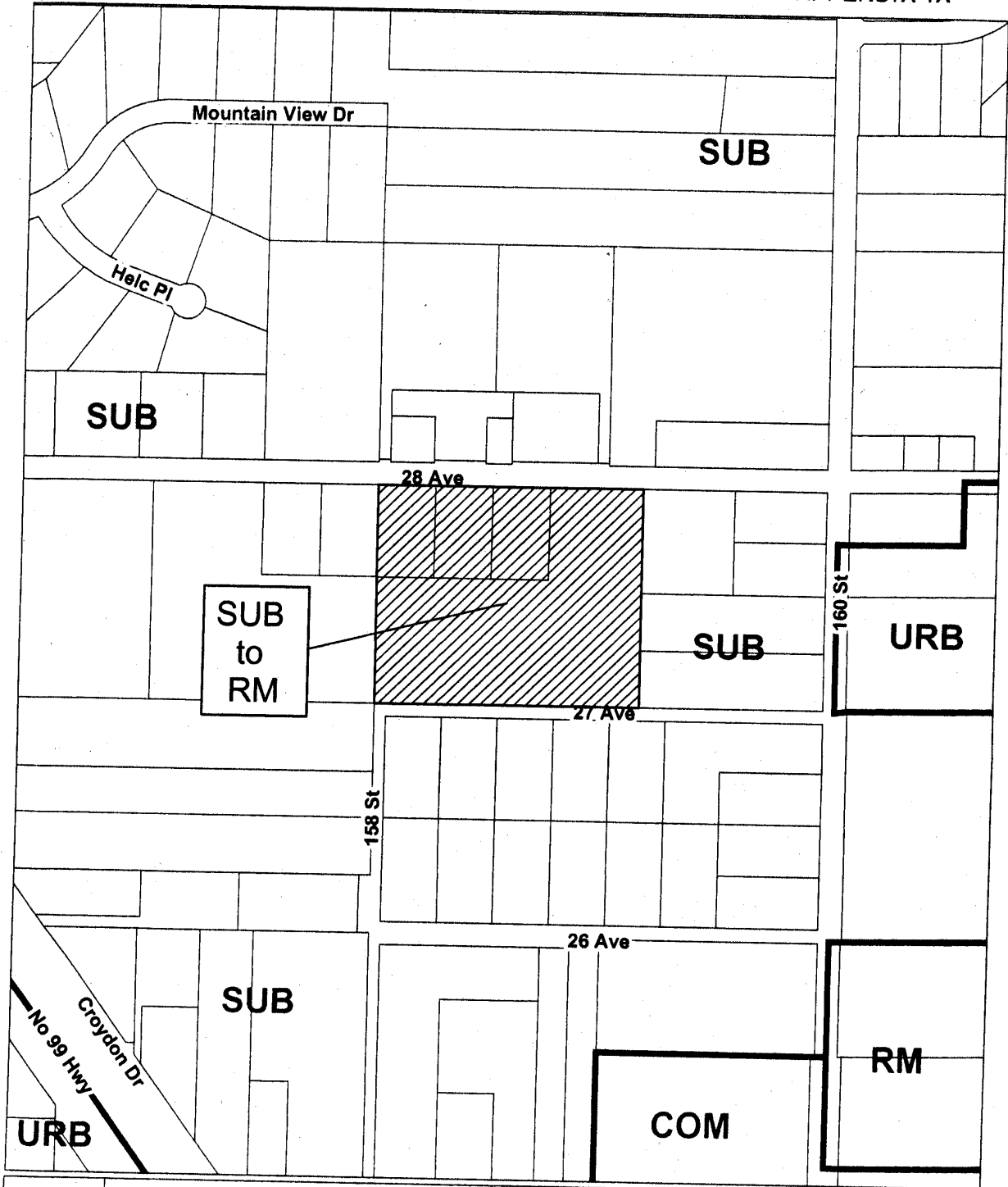

OCP Amendment

Proposed amendment from Suburban to Multiple Residential

