

CITY OF SURREY

BY-LAW NO. 17605

A by-law to amend the provisions of "Surrey Official
Community Plan By-law, 1996, No. 12900," as amended.

.....

The Council of the City of Surrey, in open meeting assembled, ENACTS AS FOLLOWS:

1. That portion of the map designated as Schedule A. Land Use Designation Map, Division A of "Surrey Official Community Plan By-law, 1996, No. 12900," as amended as shown outlined black on the plan attached hereto and designated as "Amendment to Schedule A, Land Use Designation Map" is hereby amended as follows:

FROM: SUBURBAN (SUB)

TO: MULTIPLE RESIDENTIAL (RM)

Portion of Parcel Identifier: 028-271-971

Lot 1 Section 23 Township 1 New Westminster District Plan BCP45196

(Portion of 2660 Croydon Drive)

Parcel Identifier: 028-271-998

Lot 3 Section 23 Township 1 New Westminster District Plan BCP45196

(2687 - 158 Street)

2. This By-law shall be cited for all purposes as "Surrey Official Community Plan By-law, 1996, No. 12900, No. 314 Amendment By-law, 2012, No. 17605."

PASSED FIRST AND SECOND READING on the 12th day of March, 2012.

PUBLIC HEARING HELD thereon on the 2nd day of April, 2012.

PASSED THIRD READING on the 2nd day of April, 2012.



RECONSIDERED AND FINALLY ADOPTED, signed by the Mayor and Clerk, and sealed with the Corporate Seal on the 23rd day of July, 2012.

_____MAYOR

_____CLERK

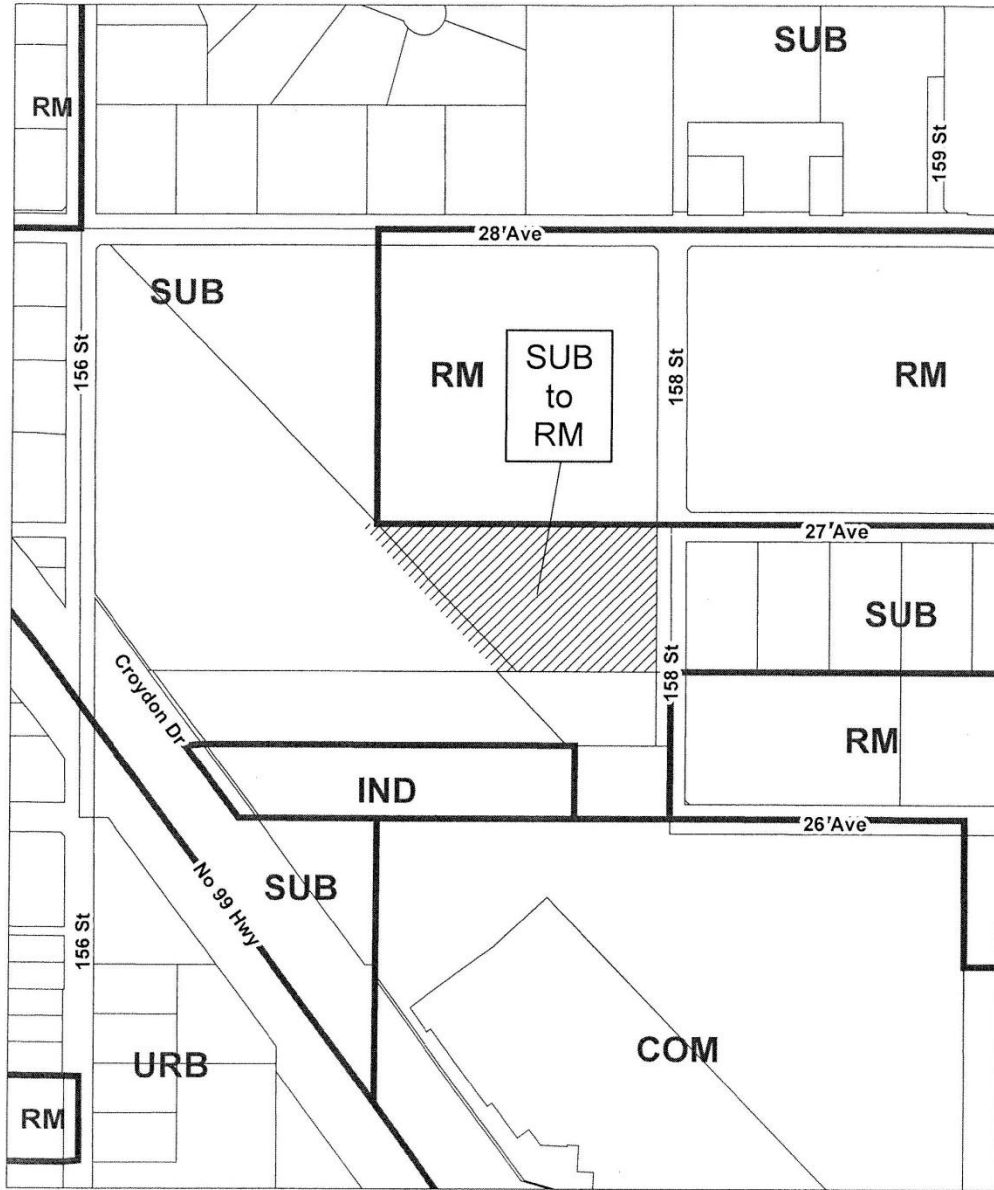
Schedule A



 <p>CITY OF SURREY the future lives here.</p>	<p>OCP Amendment Proposed amendment from Suburban to Multiple Residential</p>	 <p>N</p>
---	---	--