

CITY OF SURREY

BY-LAW NO. 17904

A by-law to amend the provisions of "Surrey Official  
Community Plan By-law, 1996, No. 12900," as amended.

.....  
The Council of the City of Surrey ENACTS AS FOLLOWS:

1. That portion of the map designated as Schedule A. Land Use Designation Map, Division A of "Surrey Official Community Plan By-law, 1996, No. 12900," as amended as shown outlined black on the plan attached hereto and designated as "Amendment to Schedule A, Land Use Designation Map" is hereby amended as follows:

FROM: SUBURBAN (SUB)  
TO: URBAN (URB)

Parcel Identifier: 010-382-089  
Lot 3 Section 13 Township 1 New Westminster District Plan 18260  
(16464 - 23 Avenue)

Parcel Identifier: 010-382-135  
Lot 5 Section 13 Township 1 New Westminster District Plan 18260  
(2235 - 165 Street)

Parcel Identifier: 010-382-101  
Lot 4 Section 13 Township 1 New Westminster District Plan 18260  
(2265 - 165 Street)

2. This By-law shall be cited for all purposes as "Surrey Official Community Plan By-law, 1996, No. 12900, No. 350 Amendment By-law, 2013, No. 17904".

PASSED FIRST READING on the 8th day of April, 2013.

PASSED SECOND READING on the 8th day of April, 2013.

PUBLIC HEARING HELD thereon on the 22nd day of April, 2013.

PASSED THIRD READING on the 22nd day of April, 2013.

RECONSIDERED AND FINALLY ADOPTED, signed by the Mayor and Clerk, and sealed with the Corporate Seal on the 25th day of November, 2013.

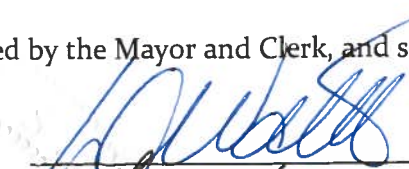
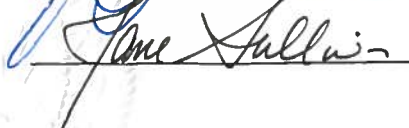
 \_\_\_\_\_ MAYOR  
 \_\_\_\_\_ CLERK

SCHEDULE A

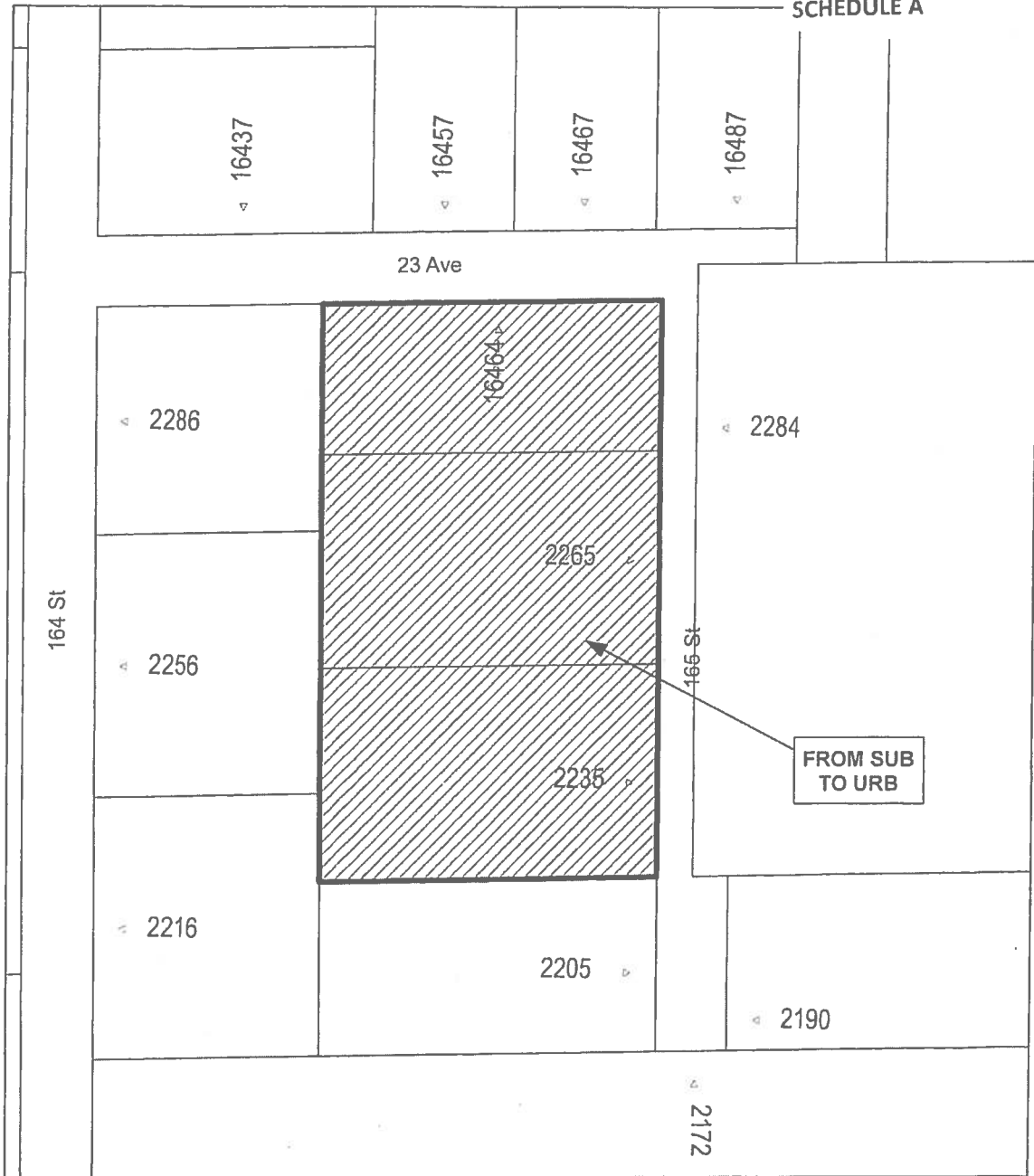

OCP Amendment

Proposed amendment from  
Suburban to Urban

