

CITY OF SURREY

BYLAW NO. 21020

A Bylaw to provide for the exemption from taxation
of certain properties in the City of Surrey pursuant to
Section 224 of the *Community Charter*

.....

WHEREAS Council may, by authority of Section 224 of the *Community Charter*, S.B.C. 2003,
Chap. 26, exempt from taxation certain properties;

AND WHEREAS Council deems it expedient to exempt from taxation the properties listed in
Schedule A, Schedule B and Schedule C, attached hereto;

NOW, THEREFORE, Council of the City of Surrey enacts as follows:

Title

1. This Bylaw may be cited as the "Section 224 Tax Exemption Bylaw, 2023, No. 21020".

Exemptions

2. The lands or improvements, or portions thereof, as outlined in Schedule A attached hereto, are hereby exempt from taxation for the Year 2024 pursuant to Section 224 of the *Community Charter*, subject to the conditions provided for in this Bylaw.
3. The lands or improvements, or portions thereof, as outlined in Schedule B attached hereto, are hereby exempted from taxation for the Year 2024 pursuant to Section 224 of the *Community Charter*, subject to the conditions provided for in this Bylaw.
4. A proportionate amount of the lands or improvements, as shown on Schedule C attached hereto, are hereby exempted from taxation for the Year 2024 pursuant to Section 224 of the *Community Charter*, subject to the conditions provided for in this Bylaw.

Conditions

5. Where:
- (a) a transfer, sale, or lease is made of property exempt from taxation under this Bylaw to some person not entitled to such exemption; or
 - (b) property used for some purpose which would entitle it to exemption under this Bylaw ceases to be so used; or
 - (c) property exempt from taxation under this Bylaw ceases to meet the conditions necessary to qualify for the exemption including, but not limited to, compliance with City policies and bylaws,
- the property shall be liable to taxation from the date of the transfer, sale, lease, or change of use or conditions, as the case may be (the "Taxation Date").
6. Where the assessment roll is completed before the transfer, sale, lease or change of use or conditions described in Section 3 of this Bylaw comes to the attention of the collector:
- (a) the collector will provide written notice to the transferee, purchaser, lessee, or other person who, but for the exemption, would have been liable to taxation; and
 - (b) the person described in (a) shall pay to the City an amount equal to the total taxes that, but for the exemption, would have been payable on the property from the Taxation Date, together with interest compounded annually at the rate described in Section 246 of the *Community Charter*.

Repeal Section

7. " Section 224 Tax Exemption Bylaw, 2022, No. 20734" is hereby repealed.



PASSED FIRST READING on the 11th day of September, 2023.

PASSED SECOND READING on the 11th day of September, 2023.

PASSED THIRD READING on the 11th day of September, 2023.

NOTICE OF INTENTION ADVERTISED in the Surrey Now Leader, Peace Arch, and Cloverdale Reporter Newspapers on the 28th day of September and 5th day of October, 2023.

RECONSIDERED AND FINALLY ADOPTED, signed by the Mayor and Clerk and sealed with the Corporate Seal on the 16th day of October, 2023.

MAYOR

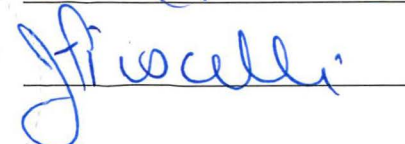
CLERK

SCHEDULE A

Section 224 Tax Exemption Bylaw, 2023, No. 21020

Owned and Occupied by the Not-for-Profit

	PID	LEGAL	Name	Address	Folio No.
1.	025-838-741	Strata Lot 44, Section 30 Township 2 NWD District Plan BCS15, together with an interest in the common property in proportion to the unit entitlement of the Strata Lot as shown on Form V	Akal Academy Society 224(2)(a)	#204, 12639-80 Avenue	6301-98250-2
2.	011-040-971	Block "G", District Lot 52, Group 2, NWD, Plan 6706	Association of Neighbourhood Houses of BC 224(2)(a)	Portion of 12210 Agar Street	5700-95102-2
3.	009-102-507	Lot "E", District Lot 52, Group 2, NWD, Plan 3675	Association of Neighbourhood Houses of BC (Camp Alexandra) 224(2)(a)	2916 McBride Avenue	5700-94002-4
4.			Atira Women's Resource Society 224(2)(a)	Shelter for Abused Women 55 and older CONFIDENTIAL	
5.			Atira Women's Resource Society 224(2)(a)	Women's Shelter CONFIDENTIAL	
6.			Atira Women's Resource Society 224(2)(a)	Shelter for Abused Women and Children CONFIDENTIAL	

	PID	LEGAL	Name	Address	Folio No.
7.	025-373-340	Lot A, Section 35, Township 2, NWD Plan LMP 53173	B.C. Family Hearing Resource Centre 224(2)(a)	15220 – 92 nd Avenue	6359-90020-8
8.	016-036-263	Strata Lot 41, Section 20, Township 2, NWD, Strata Plan NW3244, together with an interest in the common property in proportion to the unit entitlement of the strata lot as shown on Form 1	B.C. Genealogical Society 224(2)(a)	#211 – 12837 – 76 Avenue	6203-98059-6
9.	012-011-762	Lot 1, Block 4, District Lot 365, Group 2, NWD Plan 1143 (with exempt portion shown shaded on map attached hereto)	BC SPCA 224(2)(a)	Portion of 16748 – 50 Avenue	8700-00008-5
10.	023-153-628	Strata Lot 1, Section 4, Township 9, NWD Strata Plan LMS2076, together with an interest in the common property in proportion to the unit entitlement of the strata lot as shown on Form 1	BC Wildlife Federation 224(2)(a)	Unit 101, 9706 – 188 Street	9041-98001-5
11.	018-962-904	Lot 1, Section 14, Block 5 North, Range 1 West, NWD Plan LMP 19036	Bethesda Christian Association 224(2)(a)	16321 – 108 Avenue	1141-00014-3
12.	011-166-894	Lot 40, Section 8, Township 8, NWD Plan 5067	Buddhist Compassion Relief Tzu Chi Foundation of Canada 224(2)(a)	5724 – 176 Street	8082-39006-2
13.	029-576-288 029-576-270	Lot 15 and Lot 16, Section 17, Township 8, NWD Plan EPS2815, together with an interest in the common property in proportion to the unit entitlement of the strata lot as shown on Form V	Coast Hills Community Church 224(2)(a)	Units 108 and 109, 17828 - 65A Avenue	8172-98153-3 8172-98152-1
14.	003-134-181	Lot 14, Section 35, Township 2, NWD Plan 71026	Community Living Society 224(2)(a)	15293 – 95 Avenue	6353-13005-3

	PID	LEGAL	Name	Address	Folio No.
15.	000-728-942	Lot 7, Section 34, Block 5 North, Range 1 West, NWD Plan 2583 Except Plan BCP45742	Community Living Society 224(2)(a)	15659 – 96 Avenue	1340-06002-4
16.	018-546-391	Lot 41, Section 28, Township 2, NWD Plan LMP 13196	Community Living Society 224(2)(a)	8041 Coopershawk Court	6281-40003-3
17.	002-012-171	Strata Lot 1, Section 21, Range 2, NWD Plan NWS1822, together with an interest in the common property in proportion to the unit entitlement of the strata lots as shown on Form 1	Connective Support Society 224(2)(a)	12817 – 104 Avenue	2210-98003-3
18.	002-012-189	Strata Lot 2, Section 21, Range 2, NWD Plan NWS1822 together with an interest in the common property in proportion to the unit entitlement of the strata lots as shown on Form 1	Connective Support Society 224(2)(a)	12819 – 104 Avenue	2210-98004-5
19.	6212-99048-7	Strata Lot 12, Section 21, Township 2, NWD Plan LMS1680 together with an interest in the common property in proportion to the unit entitlement of the strata lots as shown on Form 1	DIVERSEcity Community Resources 224(2)(a)	1107, 7330 – 137 Street	019-013-621
20.	029-260-515	Lot 1, Section 20, Township 2, NWD Plan EPP31770, except that 950 square foot portion used as a retail store	DIVERSEcity Community Resources 224(2)(a)	Portion of 13455 – 76 Avenue	6204-00041-X
21.	004-945-166	Lot 8, NWD Plan 72600	Elizabeth Fry Society 224(2)(a)	11187 Ellendale Drive	4000-07003-4
22.			Elizabeth Fry Society 224(2)(a)	Women's Shelter - CONFIDENTIAL	

	PID	LEGAL	Name	Address	Folio No.
23.	002-053-641	Lot 16, Section 18, Block 5 North, Range 1 West, NWD Plan 15157, Except part in Plan BCP11170	Fraser Regional Aboriginal Friendship Association – Awahsuk Aboriginal Head Start 224(2)(a)	14589 – 108 Avenue	1182-15002-0
24.	006-228-798	Lot 27, Section 27, Township 2, NWD Plan 48043	Fraser Regional Aboriginal Friendship Association 224(2)(a)	14756 – 88 Avenue	6273-26004-7
25.	018-329-900 018-329-918	That 3,918 square foot portion of Strata Lots 14 and 15, all of Section 29, Township 2, NWD, LMS949, used for charitable purposes, together with an interest in the common property in proportion to the unit entitlement of the strata lots as shown on Form 1 (except the upper floor which is leased to a private firm)	Greater Vancouver Youth for Christ 224(2)(a)	114 & 115 – 12975 – 84 Avenue	6293-98033-5 6293-98034-7
26.	005-511-542	Lot 2, Section 20, Township 1, NWD Plan 73190 (except that 800 square foot portion of the building used as living quarters)	Imitating Christ Ministries 224(2)(a)	Portion of 12969 Crescent Road	5203-01001-8
27.	011-253-185	Lot "B", Except: Firstly: Part Subdivided by Plan 37396, Secondly: Part on SRW Plan 53885, Section 31, Township 2, NWD Plan 6922	Kennedy Community Hall Association 224(2)(a)	8870 – 120 Street	6312-91001-5
28.	004-322-258	Lot 67, Section 28, Range 2, NWD Plan NWP31690	Lookout Housing and Health Society 224(2)(a)	10008 and 10010 – 128 Street	2280-58001-9
29.	010-926-429	Lot 6, Block 136, NWD Plan 2546, Except Plan BCP49645	Masonic Building Association of North Surrey 224(2)(a)	14042 Grosvenor Road	4000-05074-6

	PID	LEGAL	Name	Address	Folio No.
30.	030-357-551	Lot 4 Block 5N Section 9 Range 2W NWD Plan EPS4771 together with an interest in the common property in proportion to the unit entitlement of the strata lot as shown on Form V	Muslim Food Bank and Community Services Society 224(2)(a)	104 - 12941 - 115 Avenue	2090-98064-3
31.	025-665-821	Strata Lot 99, Section 29, Township 2, NWD Strata Plan4521, together with an interest in the common property in proportion to the unit entitlement of the strata lots as shown on Form V	On the Water Rich Media Ministry 224(2)(a)	115 - 13045 - 84 Avenue	6293-98253-8
32.	001-093-339	Lot 204, Section 20, Township 2, NWD Plan 62200	Options Community Services Society 224(2)(a)	13520 - 78 Avenue	6204-85302-8
33.	003-154-050	Lot 493, Section 17, Township 2, NWD Plan 62718	Options Community Services Society 224(2)(a)	13582 - 68 Avenue	6171-48010-1
34.			Options Community Services Society 224(2)(a)	Shelter for Abused Women and Children CONFIDENTIAL	
35.			Options Community Services Society (Evergreen) 224(2)(a)	Shelter for Abused Women and Children CONFIDENTIAL	
36.	009-770-372	Parcel "One" (Explanatory Plan 14541) Except Part in Plan BCP8341, Lot "A", Section 35, Block 5 North, Range 2 West, NWD Plan 13113	Options Community Services Society 224(2)(a)	9803 - 140 Street	2350-00028-X
37.	029-948-720	Lot 1, Section 14, Township 1, NWD Plan EPP63224	Peace Arch Hospice Society 224(2)(a)	15435 - 16A Avenue	5142-00068-7

	PID	LEGAL	Name	Address	Folio No.
38.	001-439-588	Lot 6, Except: Part on Plan BCP17863, Section 33, Township 2, NWD Plan 11488 (except that 15,287 sq. ft. portion of the improvements used for low-cost housing)	Phoenix Drug & Alcohol Recovery and Education Society 224(2)(a)	13686 – 94A Avenue	6333-05006-4
39.	029-583-225	Air Space Parcel 1, Section 26, Block 5, Range 2 West, NWD Air Space Plan EPP41750	Phoenix Drug & Alcohol Recovery and Education Society 224(2)(a)	13959 – 100 Avenue	2260-00059-9
40.	027-026-035	Lot 1, Block 5N, Section 32, Range 2W, NWD Plan BCP29305	Phoenix Drug & Alcohol Recovery and Education Society 224(2)(a)	9942 – 127A Street	2324-00005-2
41.	010-968-415	Lot 4, District Lot 52, Group 2, NWD Plan 3340 (with exempt portion shown shaded on map attached hereto)	PLEA Community Services Society of BC 224(2)(a)	Portion of 12159 Sullivan Street	5700-03022-6
42.	006-273-891	Lot 1, Section 36, Township 2, NWD Plan 73579, Except Plan BCP48074 (with exempt portion shown shaded on map attached hereto)	PLEA Community Services Society of BC 224(2)(a)	Portion of 16590 – 96 Avenue	6364-00001-0
43.	029-845-793	Lot 1, Section 28, Township 8 NWD Plan EPP60921 (with exempt portion shown shaded on map attached hereto)	Port Kells Fire Hall No. 7 224(2)(a)	Portion of 18922 – 88 Avenue	8284-00015-5
44.	026-816-636 026-816-695 026-816-709 026-816-717 026-816-725 026-816-733	Lots 3, 9, 10, 11, 12, & 13, Section 30 Township 2 NWD Strata Plan BCS 2004 together with an interest in the common property in proportion to the unit entitlement of the strata lot as shown on Form V	Progressive Intercultural Community Services Society 224(2)(a)	#205, #206, #207, #208, #209, #211 – 12725 – 80 Avenue	6301-98330-0 6301-98336-1 6301-98337-3 6301-98338-5 6301-98339-7 6301-98340-3

	PID	LEGAL	Name	Address	Folio No.
45.	017-964-091	That 3,200 square foot portion of Lot 3, Section 19, Township 2, NWD Plan LMP5880 (with exempt portion shown shaded on map attached hereto)	Progressive Intercultural Community Services Society 224(2)(i)	Portion of 7566 – 120A Street	6192-02021-8
46.	029-294-975	Lot 2, Section 7, Township 8 NWD Plan EPP 24658	Royal Canadian Legion 224(2)(i)	17567 – 57 Avenue	8071-01064-9
47.	007-902-298	Lot A, Except: Parcel 2 (Bylaw Plan 62659), Section 14 Township 1 NWD Plan 13327	Royal Canadian Legion 224(2)(i)	2290 – 152 Street	5140-90016-6
48.	011-337-851	Parcel "A" (reference Plan 49172, Section 19, Township 1, NWD Plan 8545)	Royal Canadian Legion 224(2)(i)	2643 – 128 Street	5191-90014-5
49.	011-111-666	Lot 4, Section 12, Township 1, NWD Plan 9013	Sources Community Resources Society 224(2)(a)	1290 – 160 Street	5123-03006-2
50.	023-984-741 023-984-759 023-984-767 023-984-791 023-984-805 023-984-775	Strata Lots 30, 31, 32, 33, 34, & 35, Section 21, Township 2, NWD Strata Plan together with an interest in the common property in proportion to the unit entitlement of the strata lot as shown on Form 1	Sources Community Resources Society 224(2)(a)	Units 102, 104, 105, 106, 107, & 110 – 13771 – 72A Avenue	6212-99272-1 6212-99273-3 6212-99274-5 6212-99276-9 6212-99277-0 6212-99275-7
51.	007-617-461	Lot 1, Section 14, Township 1, NWD Plan 20734	Sources Community Resources Society 224(2)(a)	1951 King George Boulevard	5141-00018-7
52.	003-676-404	Lot 1, Section 14, Township 1, NWD Plan 71395	Sources Community Resources Society 224(2)(a)	15318 – 20 Avenue	5142-00043-2

	PID	LEGAL	Name	Address	Folio No.
53.	008-058-687	Lot "A", Section 14, Township 1, NWD Plan 12865	Sources Community Resources Society 224(2)(a)	2343 - 156 Street	5140-90006-3
54.	023-869-119	That 2,013 square foot portion of Lot 2, Section 3, Township 8 Plan LMS2872 NWD	Sources Community Resources Society (Langley Food Bank) 224(2)(a)	2 - 5492 Production Boulevard	8033-98013-8
55.	015-151-077	Lot 3, Section 15, Township 1, NWD Plan 83184, Except Plans LMP36078 and BCP46838 (with exempt portion shown shaded on map attached hereto)	South Surrey Field House Society 224(2)(i)	Portion of 2197 - 148 Street	5153-02007-1
56.	010-328-211	Lot 4, Section 19, Block 5 North, Range 1 West, NWD Plan 17705	Strive Living Society 224(2)(a)	14557 - 105A Avenue	1190-03018-4
57.	001-402-293 001-402-307 001-402-323 001-402-331	Strata Lots 1, 2, 3, & 4, Section 8, Township 8, NWD Strata Plan NW517, together with an interest in the common property in proportion to the unit entitlement of the strata lot as shown on Form 1	Surrey Association for Community Living 224(2)(a)	101 - 17687 - 56A Avenue 102 - 17687 - 56A Avenue 201 - 17687 - 56A Avenue 202 - 17687 - 56A Avenue	8082-98501-X 8082-98502-1 8082-98503-3 8082-98504-5
58.	012-520-527	Lot 22, Block 14, Section 8, Township 8, NWD Plan 2107	Surrey Association for Community Living 224(2)(a)	17677 - 56A Avenue	8082-21008-4
59.	018-927-327	Lot 11, Section 9, Township 8, NWD Plan LMP18689	Surrey Association for Community Living 224(2)(a)	18919 - 62A Avenue	8094-10027-8
60.	016-941-420	Strata Lot 15, Section 30, Township 2, NWD Strata Plan NWS3424, together with an interest in the common property in proportion to the unit entitlement of the strata lot as shown on Form 1	Surrey Crime Prevention Society 224(2)(a)	15 - 12484 - 82 Avenue	6301-98081-5

	PID	LEGAL	Name	Address	Folio No.
61.	015-340-759 015-340-767 015-340-775 015-340-783 015-340-791 015-340-805 015-340-813	Lots 1, 2, 3, 4, 5, 6 and 7, Section 20, Township 2, NWD Plan NWS3116 Part NE 1/4, together with an interest in the common property in proportion to the unit entitlement of the strata lot as shown on Form 1 or V, as appropriate	Surrey Food Bank Foundation 224(2)(a)	Units 1-7, 13478 – 78 Avenue	6204-98070-1 6204-98071-3 6204-98072-5 6204-98073-7 6204-98074-9 6204-98075-0 6204-98076-2
62.	009-574-492	Lot A, Section 23, Block 5 North, Range 2 West, NWD Plan 11670	Surrey Urban Mission Society 224(2)(a)	10776 King George Boulevard	2238-90004-4
63.	005-036-097	Lot 3, Except: Firstly; Part Dedicated Road on Plan BCP433, Secondly; Part Dedicated Road on Plan BCP8561; Section 33, Township 2, NWD Plan 52522	The Centre for Child Development of the Lower Mainland 224(2)(a)	9460 – 140 Street	6334-02002-X
64.	029-313-988 029-313-996 029-314-003 029-314-011 029-314-020 029-314-038 029-314-046 029-314-054 029-214-062	Lots 70 to 78 inclusive, Block 5 North, Section 35, Range 2 West, NWD Plan EPS1615, together with an interest in the common property in proportion to the unit entitlement of the strata lot as shown on Form V	The Children's Foundation 224(2)(a)	Units 1001 to 1009, 13737 – 96 Avenue	2350-99469-7 2350-99470-3 2350-99471-5 2350-99472-7 2350-99473-9 2350-99474-0 2350-99475-2 2350-99476-4 2350-99477-6
65.	018-564-569 018-564-577	Strata Lots 8 & 9, Section 20, Township 2, NWD Strata Plan LMS 1181 together with an interest in the common property in proportion to the unit entitlement of the strata lots as shown on Form 1	The Muslim Youth Centre 224(2)(a)	#208 & 209 – 7750 – 128 Street	6203-98092-4 6203-98093-6
66.	018-699-065	Lot 4, Section 7, Township 9, NWD Plan LMP15379	The Nature Conservancy of Canada 224(2)(a)	17055 – 106 Avenue	9072-03004-7

	PID	LEGAL	Name	Address	Folio No.
67.	001-131-591	Lot 23, Section 7, Township 9, NWD Plan 1799	The Nature Conservancy of Canada 224(2)(a)	17122 – 106 Avenue	9072-22002-X
68.	001-131-621	Lot 24, Section 7, Township 9, NWD Plan 1799	The Nature Conservancy of Canada 224(2)(a)	17174 – 106 Avenue	9072-23002-4
69.	024-842-966	Lot 16, Section 7, Township 9, NWD Plan LMP47179	The Nature Conservancy of Canada 224(2)(a)	17215 – 104 Avenue	9071-15001-X
70.	018-699-057	Lot 3, Section 7, Township 9, NWD Plan LMP15379	The Nature Trust of BC 224(2)(a)	17179 – 106 Avenue	9072-02004-2
71.	011-343-494	North Half Lot 16, Section 14, Township 1, NWD Plan 8492	The Semiahmoo House Society 224(2)(a)	2365 -153A Street	5140-15006-2
72.	025-259-253	Parcel 1, Section 14, Township 1, NWD Plan LMP52718	The Semiahmoo Foundation 224(2)(a)	15306 – 24 Avenue	5140-00065-9
73.	001-811-061 001-811-100 001-811-118	Strata Lots 3, 5, & 6, Section 20, Township 2, NWD Strata Plan NW1473 NWD together with an interest in the common property in proportion to the unit entitlement of the Strata Lot as shown on Form 1	The Semiahmoo Foundation 224(2)(a)	#3, #5, #6, 13550 – 77 Avenue	6204-98015-4 6204-98017-8 6204-98018-X
74.	003-739-872	Lot A, Section 19, Township 1, NWD Plan 71424	The Semiahmoo House Society 224(2)(a)	12698 – 25 Avenue	5191-90011-X

	PID	LEGAL	Name	Address	Folio No.
75.	028-125-592	Lot 1, Section 35, Block 5 North, Range 2 West, NWD Plan BCP 43477	Whalley & District Senior Citizen Housing Society (Kinsmen Place Lodge) 224(2)(a)	9650 - 137A Street	2350-00055-2
76.	n/a	NWD	White Rock City	Water mains infrastructure servicing residents of Surrey	9905-00010-0

SCHEDULE A

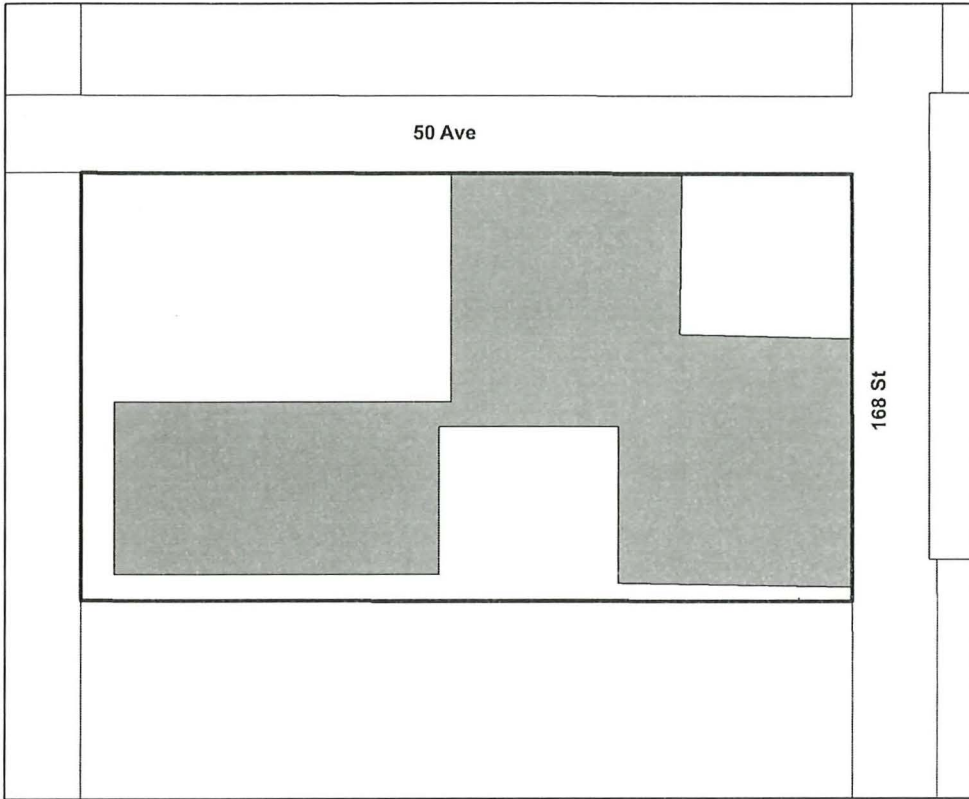

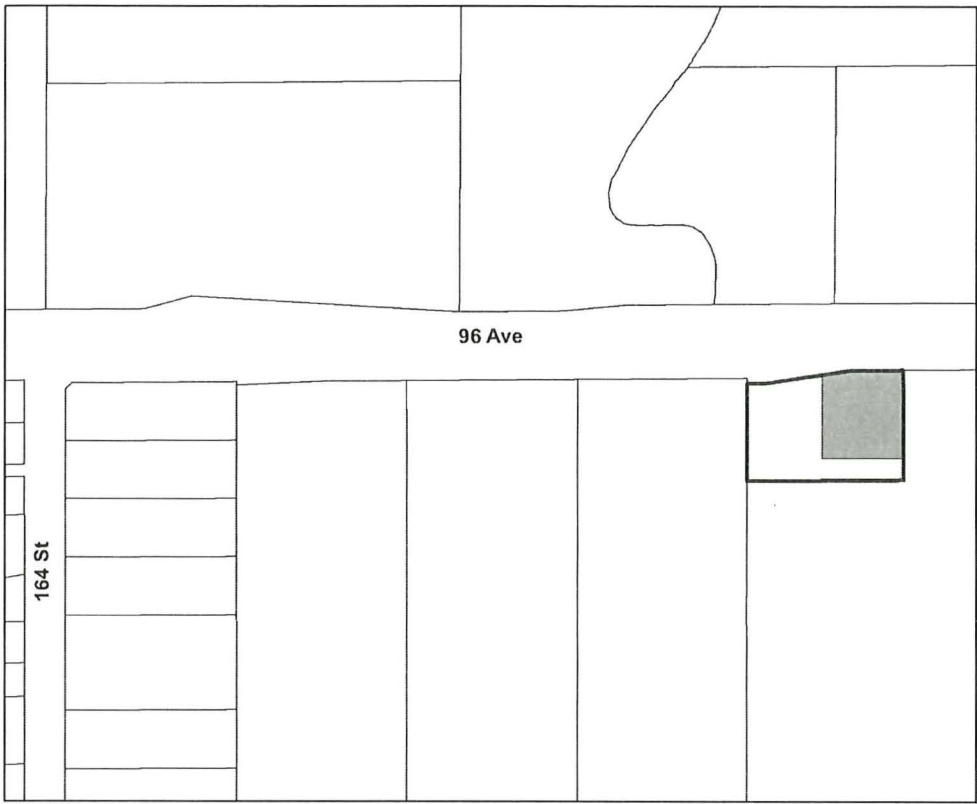

PLEA Community Services
 Folio: 6364-00001-0
 16590 96 Ave

Legend
 ■ EXEMPT: 1673 Sq/m
 □ NOT EXEMPT: 2182 Sq/m
 □ Total Area: 3855 Sq/m

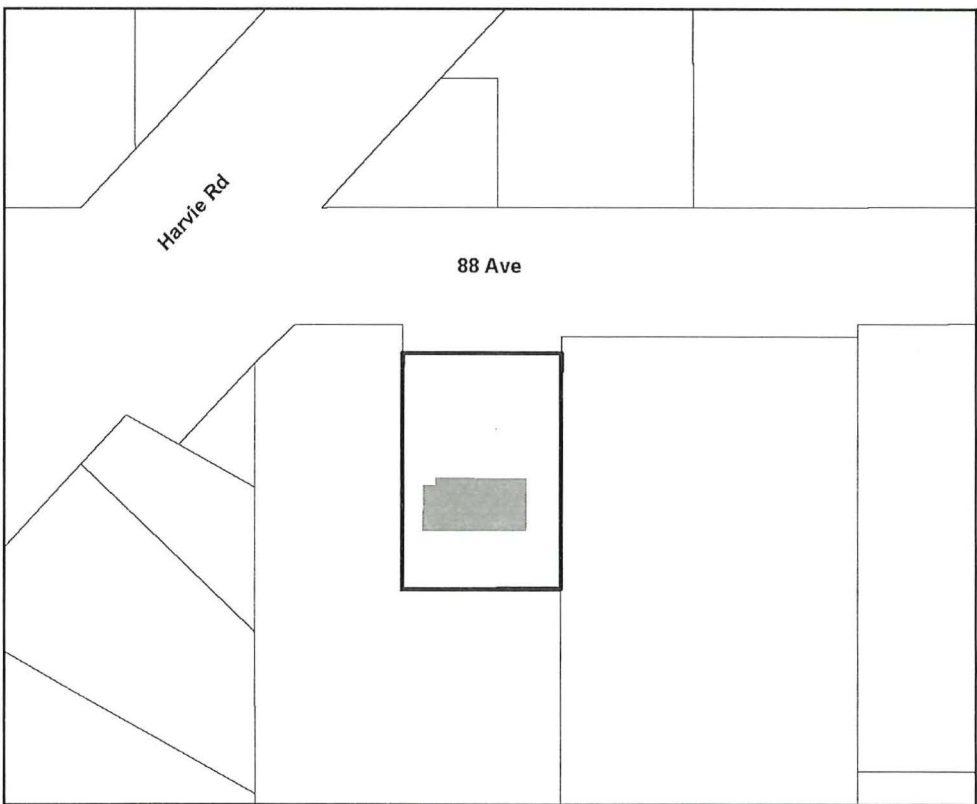

Port Kells Fire Hall No 7
 Folio: 8284-00015-5
 18922-88 Ave



Legend
 ■ EXEMPT: 160 Sq/m
 □ NOT EXEMPT: 958 Sq/m
 □ Total Area: 1118 Sq/m





Progressive Intercultural
Community Services
Society
Folio: 6192-02021-8
7566 120A Ave

Legend

-  EXEMPT: 421 Sq/m
-  NOT EXEMPT: 5563 Sq/m
-  Total Area: 5984 Sq/m

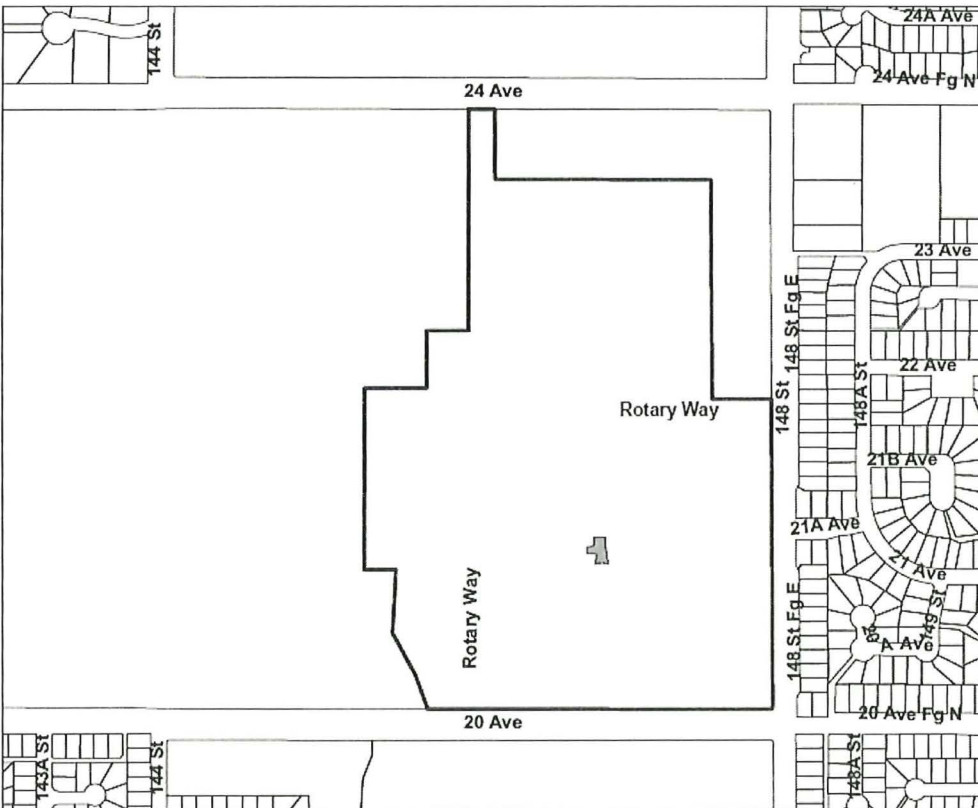

South Surrey Field
House Society
Folio: 5153-02007-1
2197 148 St

Legend

-  EXEMPT: 586 Sq/m
-  NOT EXEMPT: 295553 Sq/m
-  Total Area: 296138 Sq/m



SCHEDULE B

Section 224 Tax Exemption Bylaw, 2023, No. 21020

Leased by the Not-for-Profit from City

	PID	LEGAL	Name	Address	Folio No.
1.	015-151-077	That 46,619 square foot (4,331 square metre) portion of Lot 3, Section 15, Township 1, Plan 83184 NWD Except Plans LMP36078 and BCP46838 (with exempt portion shown shaded on map attached hereto)	Coastal Football Club 224(2)(d)	Portion of 2201 – 148 Street	5153-02008-3
2.	024-214-566	Lot A, District Lots 52, 231 and 491, Group 2 and the Fractional North East 1/4 of Section 19, Township 1, NWD Plan LPM38916	Crescent Beach Swimming Club 224(2)(d)	3136 McBride Avenue	5700-97168-9 (Lot 231) 5700-97166-5 (Lot 491)
3.	027-239-306	Parcel 77, Section 5, Township 8, NWD Plan BC32766, Except: Plan BCP47956	Fraser Valley Heritage Railway Society 224(2)(d)	5554 – 176 Street	8053-63001-7
4.	005-674-387	That 50% portion of Lot 1, Section 29, Township 2, NWD Plan LMP7745; AND That 50% portion of Lot 17, Except: Firstly; Part Dedicated Road on Plan LMP43347, Secondly: Part Subdivided by Plan LMP46782, Section 29, Township 2, NWD Plan 28729	Kerala Christian Fellowship 224(2)(d)	8599 – 132 Street & 8613 – 132 Street	6293-16009-5
5.	011-384-573	Lot 66, Section 22, Block 5 North, Range 2 West, NWD Plan 9117	Lookout Housing and Health Society 224(2)(d)	10667 – 135A Street	2220-57502-0

	PID	LEGAL	Name	Address	Folio No.
6.	011-384-549	That 5,000 square foot portion (lower floor) of Lot 63, Section 22, Block 5 North, Range 2 West, NWD Plan 9117	Lookout Housing and Health Society 224(2)(d)	10697 - 135A Street	2220-56002-8
7.	009-893-288	East Half of the North West Quarter Section 27, Township 7, Except: Firstly: the North Three Quarters and Secondly: Parcel A (Bylaw Plan 64907), Thirdly: Parcel 1 (Statutory Right of Way Plan 64908 and Fourthly: Parcel 2 (Statutory Right of Way Plan 64908) NWD (with exempt portion shown shaded on map attached hereto)	Lower Mainland German Shepherd Dog Club 224 (2)(d)	Portion of 19495 - 36 Avenue (also known as 19461-36 Ave)	7273-97103-0
8.	009-770-381	Lot A, Section 35, Block 5 North, Range 2 west, NWD Plan 13113 Except: Firstly; Parcel One (Explanatory Plan 14541), Secondly; Part Dedicated Road on Plan LMP14905, Thirdly; Part Dedicated Road on Plan BCP40077	Options Community Services Society 224(2)(d)	9815 - 140 Street	2350-90012-5
9.	002-384-400	Parcel "A" (Reference Plan 8568), Except part in Plan BCP12927 of the Northwest Quarter of Section 6, Township 2, NWD (with exempt portion shown shaded on map attached hereto)	Panorama Ridge Riding Club 224(2)(d)	Portion of 5435 - 123 Street	6063-90014-7
10.	018-417-175	Parcel C (Bylaw Plan LMP12030), Section 18, Township 2, NWD Plan 1155	Satnam Education Society of BC 224 (2)(d)	6975 - 123 Street	6183-92001-0

	PID	LEGAL	Name	Address	Folio No.
11.	024-214-566	Lot A, District Lots 52, 231 and 491, Group 2 and the Fractional North East 1/4 of Section 19, Township 1, NWD Plan LMP38916 (with exempt portion shown shaded on map attached hereto)	Surrey Sailing Club 224(2)(d)	Portion of 3140 McBride Avenue	5700-97169-0
12.	012-997-684	Parcel A, Section 22, Block 5 North, Range 2 West, NWD Reference Plan 80330	The Royal Canadian Theatre Company 224(2)(d)	10660 City Parkway	2220-90025-3

SCHEDULE B

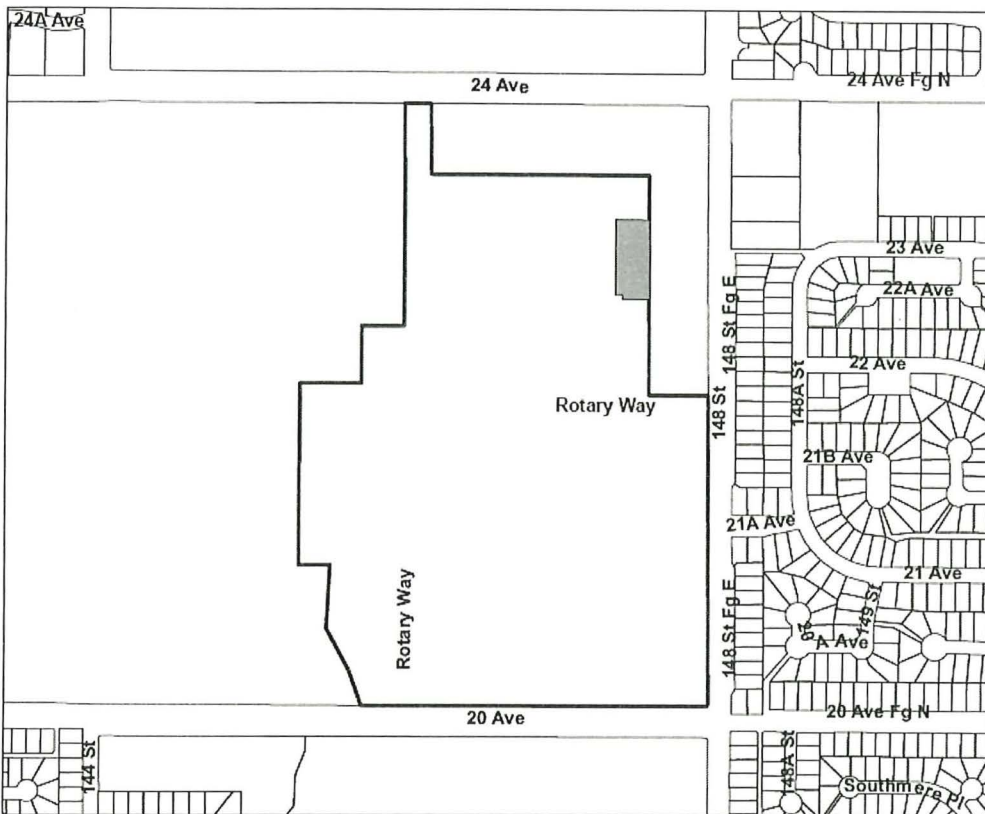

Coastal Football Club
Folio: 5153-02008-3
2201 148 St

Legend

- EXEMPT: 4331 Sq/m
- NOT EXEMPT: 291807 Sq/m
- Total Area: 296138 Sq/m

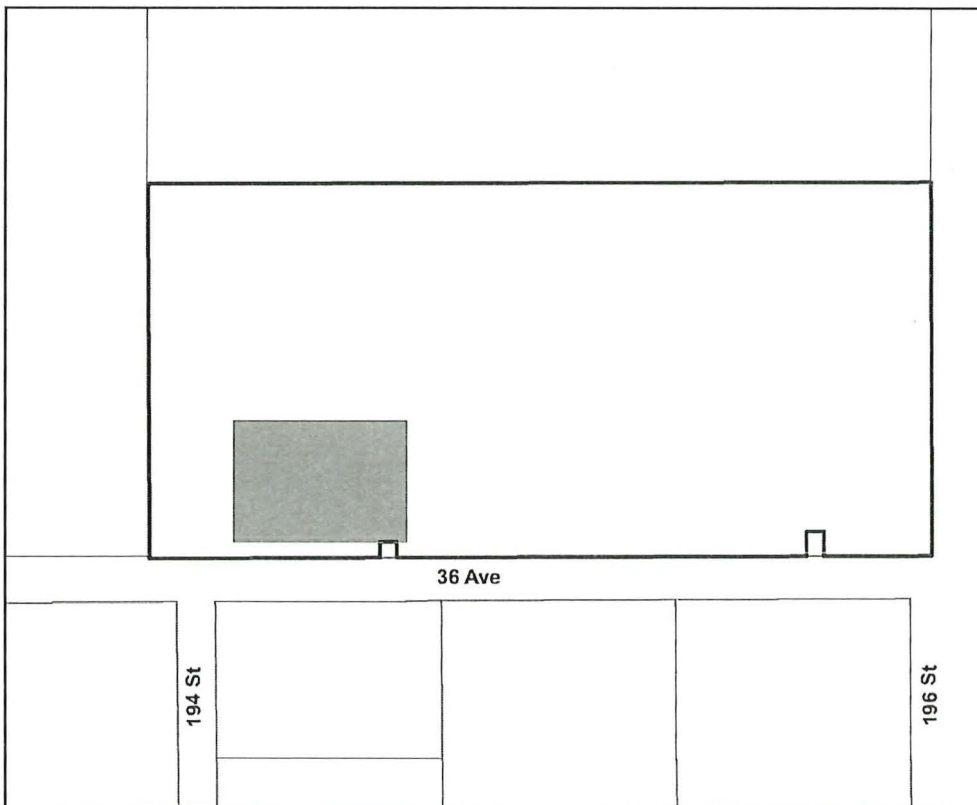

Lower Mainland German
Shepherd Dog Club
Folio: 7273-97103-0
19461 - 36 Ave
(19495 - 36 Ave)

Legend

- EXEMPT: 5485 Sq/m
- NOT EXEMPT: 71809 Sq/m
- Total Area: 77294 Sq/m





**Panorama Ridge
Riding Club**
Folio: 6063-91004-7
5435 123 St

Legend

- EXEMPT: 10940 Sq/m
- NOT EXEMPT: 104842 Sq/m
- Total Area: 115782 Sq/m

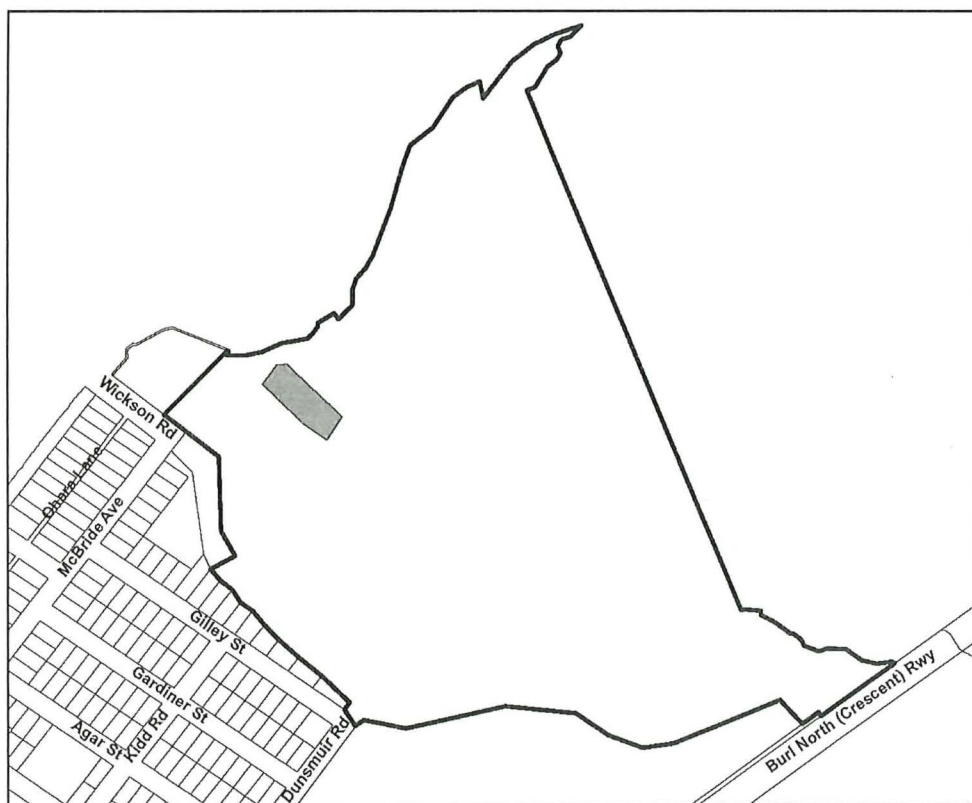

Surrey Sailing Club
Folio: 5700-97169-0
3140 McBride Ave

Legend

- EXEMPT: 2806 Sq/m
- NOT EXEMPT: 247605 Sq/m
- Total Area, 250411 Sq/m



SCHEDULE C

Section 224 Tax Exemption Bylaw, 2023, No. 21020

Care Homes – Proportionate Exemption

	PID	LEGAL	DESCRIPTION OF EXEMPTION	Name	Address	Folio No.
1.	027-393-402	Lot 1, Section 10, Township 8, NWD Plan BCP 761552	Licensed for 116 Complex Care beds of which 102 are approved for exemption	Baltic Properties (Brookside) Ltd 224(2)(j)	19550 Fraser Highway	8103-00033-4
2.	028-338-197	Lot 2, Section 16, Township 8 NWD Plan BCP46146	Licensed for 131 Complex Care beds of which 131 are approved for exemption	Clayton Heights Care Holdings 224(2)(j)	18788 - 71 Avenue	8163-01021-6
3.	023-881-097	LT 154 SEC 12 TWP 1 PL LMS2925 NWD – Unit 3301	100% exemption for listed strata units	CSH (Care Holdings) Ltd - Crescent Gardens 224(2)(j)	1222 King George Boulevard	5121-98154-5
	023-880-228	LT 86 SEC 12 TWP 1 PL LMS2925 NWD – Unit 3302				5121-98086-3
	023-881-089	LT 153 SEC 12 TWP 1 PL LMS2925 NWD – Unit 3303				5121-98153-3
	023-880-236	LT 87 SEC 12 TWP 1 PL LMS2925 NWD – Unit 3304				5121-98087-5
	023-880-244	LT 88 SEC 12 TWP 1 PL LMS2925 NWD – Unit 3306				5121-98088-7
	023-881-062	LT 151 SEC 12 TWP 1 PL LMS2925 NWD – Unit 3307				5121-98151-X
	023-880-261	LT 90 SEC 12 TWP 1 PL LMS2925 NWD – Unit 3310				5121-98090-5
	023-880-279	LT 91 SEC 12 TWP 1 PL LMS2925 NWD – Unit 3312				5121-98091-7
	023-881-038	LT 148 SEC 12 TWP 1 PL LMS2925 NWD – Unit 3313				5121-98148-X
	023-880-287	LT 92 SEC 12 TWP 1 PL LMS2925 NWD – Unit 3314				5121-98092-9

SCHEDULE C

PID	LEGAL	DESCRIPTION OF EXEMPTION	Name	Address	Folio No.
023-880-295	LT 93 SEC 12 TWP 1 PL LMS2925 NWD - Unit 3316				5121-98093-0
023-881-011	LT 146 SEC 12 TWP 1 PL LMS2925 NWD - Unit 3317				5121-98146-6
023-880-309	LT 94 SEC 12 TWP 1 PL LMS2925 NWD - Unit 3318				5121-98094-2
023-880-325	LT 96 SEC 12 TWP 1 PL LMS2925 NWD - Unit 3320				5121-98096-6
023-880-333	Lt 97 SEC 12 TWP 1 PL LMS2925 NWD - Unit 3321				5121-98097-8
023-880-341	LT 98 SEC 12 TWP 1 PL LMS2925 NWD - Unit 3322				5121-98098-X
023-880-350	LT 99 SEC 12 TWP 1 PL LMS2925 NWD - Unit 3323				5121-98099-1
023-880-368	LT 100 SEC 12 TWP 1 PL LMS2925 NWD - Unit 3324				5121-98100-4
023-881-003	LT 145 SEC 12 TWP 1 PL LMS2925 NWD - Unit 3325				5121-98145-4
023-880-384	LT 101 SEC 12 TWP 1 PL LMS2925 NWD - Unit 3326				5121-98101-6
023-880-996	LT 144 SEC 12 TWP 1 PL LMS2925 NWD - Unit 3327				5121-98144-2
023-880-988	LT 143 SEC 12 TWP 1 PL LMS2925 NWD - Unit 3329				5121-98143-0
023-880-406	LT 103 SEC 12 TWP 1 PL LMS2925 NWD - Unit 3330				5121-98103-X
023-880-970	LT 142 SEC 12 TWP 1 PL LMS2925 NWD - Unit 3331				5121-98142-9
023-880-961	LT 141 SEC 12 TWP 1 PL LMS2925 NWD - Unit 3333				5121-98141-7
023-880-422	LT 105 SEC 12 TWP 1 PL LMS2925 NWD - Unit 3334				5121-98105-3

SCHEDULE C

PID	LEGAL	DESCRIPTION OF EXEMPTION	Name	Address	Folio No.
023-880-953	LT 140 SEC 12 TWP 1 PL LMS2925 NWD - Unit 3335				5121-98140-5
023-880-431	LT 106 SEC 12 TWP 1 PL LMS2925 NWD - Unit 3336				5121-98106-5
023-880-945	LT 139 SEC 12 TWP 1 PL LMS2925 NWD - Unit 3337				5121-98139-9
023-880-457	LT 108 SEC 12 TWP 1 PL LMS2925 NWD - Unit 3340				5121-98108-9
023-880-929	LT 137 SEC 12 TWP 1 PL LMS2925 NWD - Unit 3341 A&B				5121-98137-5
023-880-465	LT 109 SEC 12 TWP 1 PL LMS2925 NWD - Unit 3342				5121-98109-0
023-880-911	LT 136 SEC 12 TWP 1 PL LMS2925 NWD - Unit 3343				5121-98136-3
023-880-473	LT 110 SEC 12 TWP 1 PL LMS2925 NWD - Unit 3344				5121-98110-7
023-880-481	LT 111 SEC 12 TWP 1 PL LMS2925 NWD - Unit 3346				5121-98111-9
023-880-601	LT 118 SEC 12 TWP 1 PL LMS2925 NWD - Unit 3347 A&B				5121-98118-1
023-880-694	LT 119 SEC 12 TWP 1 PL LMS2925 NWD - Unit 3348				5121-98119-3
023-880-716	LT 120 SEC 12 TWP 1 PL LMS2925 NWD - Unit 3349				5121-98120-X
023-880-899	LT 134 SEC 12 TWP 1 PL LMS2925 NWD - Unit 3351				5121-98134-X
023-880-767	LT 122 SEC 12 TWP 1 PL LMS2925 NWD - Unit 3352				5121-98122-3
023-880-881	LT 133 SEC 12 TWP 1 PL LMS2925 NWD - Unit 3353				5121-98133-8

SCHEDULE C

	PID	LEGAL	DESCRIPTION OF EXEMPTION	Name	Address	Folio No.
	023-880-775	LT 123 SEC 12 TWP 1 PL LMS2925 NWD - Unit 3354				5121-98123-5
	023-880-791	LT 124 SEC 12 TWP 1 PL LMS2925 NWD - Unit 3356				5121-98124-7
	023-880-864	LT 131 SEC 12 TWP 1 PL LMS2925 NWD - Unit 3357				5121-98131-4
	023-880-848	LT 129 SEC 12 TWP 1 PL LMS2925 NWD - Unit 3361				5121-98129-6
	023-880-155	LT 79 SEC 12 TWP 1 PL LMS2925 NWD - Unit 3364 A&B				5121-98079-6
	023-880-163	LT 80 SEC 12 TWP 1 PL LMS2925 NWD - Unit 3366				5121-98080-2
	023-881-127	LT 157 SEC 12 TWP 1 PL LMS2925 NWD - Unit 3367				5121-98157-0
	023-880-171	LT 81 SEC 12 TWP 1 PL LMS2925 NWD - Unit 3368				5121-98081-4
	023-880-210	LT 85 SEC 12 TWP 1 PL LMS2925 NWD - Unit 3374				5121-98085-1
4.	028-029-224	Lot 1, Section 35, Township 2, NWD Plan BCP42040	Licensed for 75 Complex Care beds of which 75 are approved for exemption	Elim Housing Society 224(2)(j)	9025 - 160 Street	6351-00038-5
5.	028-029-232	Lot 2, Section 35, Township 2, NWD Plan BCP42040	Licensed for 118 Complex Care beds of which 101 are approved for exemption	Elim Housing Society 224(2)(j)	9067 - 160 Street	6351-01035-4

SCHEDULE C

	PID	LEGAL	DESCRIPTION OF EXEMPTION	Name	Address	Folio No.
6.	023-343-443	Lot 1, Except: Part on Plan BCP29639, Section 26, Township 2, NWD Plan LMP27235	Licensed for 66 Complex Care beds of which 53 are approved for exemption	Evergreen Cottages 224(2)(j)	15640 – 84 Avenue	6261-00038-4
7.	025-739-310	Lot A, Section 25, Township 2, NWD Plan BCP7288	Licensed for 108 Complex Care beds of which 95 are approved for exemption	Fleetwood Place Holdings 224(2)(j)	16011 – 83 Avenue	6252-90041-2
8.	024-912-981	Lot A, Section 19, Block 5, Range 1 West, NWD Plan LMP48242	Licensed for 98 Complex Care beds of which 81 are approved for exemption	Guildford Seniors Village Ventures Ltd. 224(2)(j)	14568 – 104A Avenue	1190-90006-3
9.	026-062-950	Lot 1, Section 15, Block 5 North, Range 2 West, NWD Plan BCP13629	Licensed for 155 Complex Care beds of which 154 are approved for exemption	Hilton Villa Care Centre 224(2)(j)	13525 Hilton Road	2150-00054-4
10.	026-797-445	Lot 1, Section 35, Block 5 North, Range 2 West, NWD Plan BCP25702	Licensed for 195 Complex Care beds of which 162 are approved for exemption	Laurel Place Care Centre Partnership 224(2)(j)	9688 – 137A Street	2350-00051-5
11.	027-160-297	Lot 1, Section 23 Township 1 NWD Plan BCP31682	Licensed for 116 Complex Care beds of which 90 are approved for exemption	Morgan Heights Care Ltd. 224(2)(j)	15955 – 27 Avenue	5230-00062-4
12.	024-860-671	Lot 2, Section 26, Township 1, NWD Plan LMP47440	Licensed for 141 Complex Care beds of which 128 are approved for exemption	Morgan Place Holdings 224(2)(j)	3288 – 156A Street	5261-01010-X

SCHEDULE C

	PID	LEGAL	DESCRIPTION OF EXEMPTION	Name	Address	Folio No.
13.	006-241-000	Parcel "One", Section 14, Township 1, NWD Reference Plan 73654	Licensed for 84 Complex Care beds of which 27 are approved for exemption	Peace Portal Lodge 224(2)(j)	15441 – 16 Avenue	5142-00045-6
14.	029-224-993	Lot 1, Section 26, Township 1, NWD Plan EPP33231	Licensed for 90 Complex Care beds of which 85 are approved for exemption	Rosemary Heights Seniors Village 224(2)(j)	15240 – 34 Avenue	5262-00032-0
15.	027-147-410	Lot 1, Section 9, Township 2, NWD Plan BCP31255	Licensed for 120 Complex Care beds of which 120 are approved for exemption	Suncreek Village 224(2)(j)	13687 – 62 Avenue	6093-00037-0