

**snəkʷəmətəʃ (NICOMEKL  
RIVERFRONT) PARK / PHASE 1**  
HADDEN MILL & OXBOW ZONES  
**FINAL CONCEPT PLAN**

We have designed the park to a conceptual level. This final concept plan is based on feedback from the public, First Nations, Surrey Urban Indigenous Leadership Committee (SUILC), Urban Indigenous Peoples, project stakeholders, project participant National Research Council of Canada, other levels of government, City staff, and nearby projects.

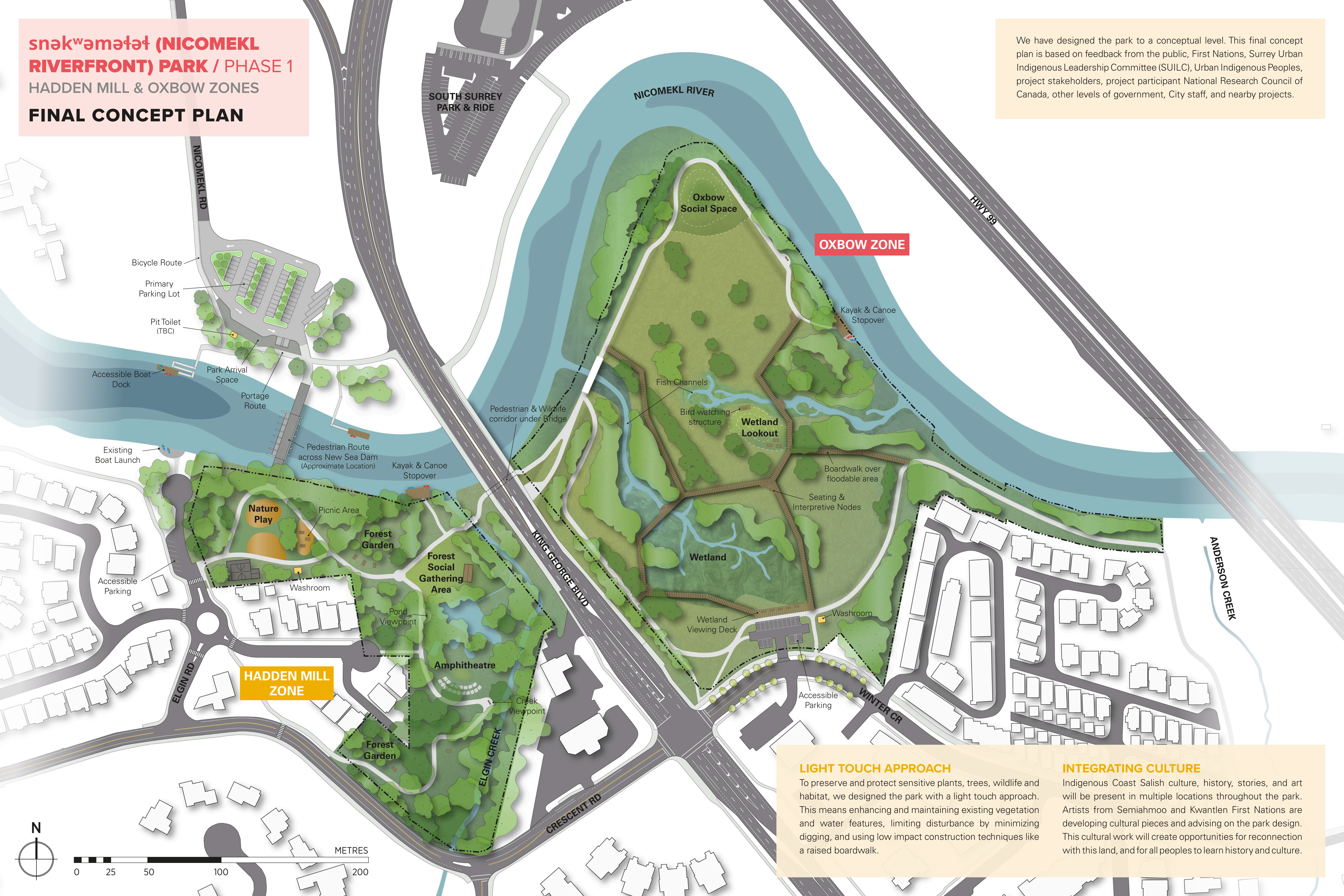

**OXBOW ZONE**

**HADDEN MILL  
ZONE**

**LIGHT TOUCH APPROACH**

To preserve and protect sensitive plants, trees, wildlife and habitat, we designed the park with a light touch approach. This means enhancing and maintaining existing vegetation and water features, limiting disturbance by minimizing digging, and using low impact construction techniques like a raised boardwalk.

**INTEGRATING CULTURE**

Indigenous Coast Salish culture, history, stories, and art will be present in multiple locations throughout the park. Artists from Semiahmoo and Kwantlen First Nations are developing cultural pieces and advising on the park design. This cultural work will create opportunities for reconnection with this land, and for all peoples to learn history and culture.

