



PROCUREMENT SERVICES

CITY OF SURREY, SURREY CITY HALL
13450 – 104 Avenue, Surrey, B.C., V3T 1V8

Tel: 604-590-7274

E-mail: purchasing@surrey.ca

ADDENDUM No. 3

INVITATION TO TENDERERS No.: 1220-020-2023-003

TITLE: GUILDFORD RECREATION CENTRE ROOF
REPLACEMENT

ADDENDUM ISSUE DATE: JUNE 12, 2023

**REVISED CLOSING DATE AND TIME: ON OR BEFORE THE FOLLOWING DATE AND
TIME (THE "CLOSING TIME"):**

TIME: 11:00 A.M. (LOCAL TIME)

DATE: JUNE 14, 2023

INFORMATION FOR TENDERERS

Tenderers are advised that Addendum No. 3 is hereby issued by the City. This addendum shall form part of the contract documents and is to be read, interpreted and coordinated with all other parts. The following information is provided to answer questions raised by Tenderers for the above-named project, to the extent referenced and shall become a part thereof. No consideration will be allowed for extras due to the Tenderers or any sub-contractor not being familiar with this addendum. This Addendum No. 3 contains three (3) pages.

CLARIFICATIONS:

1. Delete the list of separate prices table on Appendix 2 – Separate Prices of Part C – Form of Tender and replace with the following:

LINE ITEM	DESCRIPTION OF <u>SEPARATE</u> PRICE ITEMS	ADDITION \$ (exclude GST)	DEDUCTION \$ (exclude GST)
1.	Flat roof areas A, B, C: on A1.101E and A1.10F: Flat roof plan A (EL:40') – North <i>Contractor to indicate Option 1 or Option 2 for Flat Roof Plan A:</i> ___ Option 1: Roofing Contractor to perform and complete the roof replacement under the chiller and associated piping in the summer months in no more than 48 hours ___ Option 2: Roofing Contractor to perform and complete the roof replacement under the chiller and associated piping from end of September to November. Flat roof plan B (EL:23') – South Flat roof plan C (EL:45') - East	\$	\$
2.	RCABC 15 Year	\$	\$
3.	Painting Library Wall	\$	\$
4.	New snowguards (south-east and south-west corners)	\$	\$
5.	Interior Protection Scope	\$	\$
6.	Roof Anchors	\$	\$

QUESTIONS AND ANSWERS:

Q1. Please provide a supplier for these snow guards.

- .7 Snow Guards: SP2-M Snow fence for Membrane Roof. Any new Snow Guards must be accompanied by Shop Drawings stamped by a structural engineer registered in the Province of British Columbia.

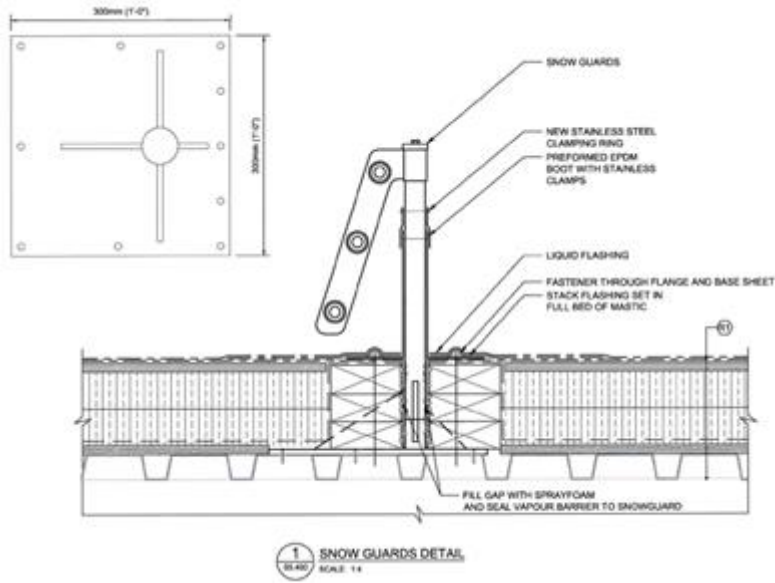

- A1. Contractors are encouraged to source a supplier for the Snow Guards.**
- Q2. Would the City be willing to waive the wrap up liability coverage and accept proof of your commercial general liability insurance with a \$10,000,000 limit. Wrap-Up Liability for roofing jobs is difficult to obtain and costly if available.**
- A2. The City will waive its requirement for Wrap-Up insurance if there are no subcontractors required for the project. Contractors are still required to provide Commercial General Liability Insurance for a limit not less than \$10,000,000.00.**

All Addenda will become part of the Contract Documents.

- END OF ADDENDUM -